

**Fire Test Report#: 0079-23-TR-03-04**

**Testing Laboratory: ESL**

**Certified by: Intertek**

**Test Standard: EN1634-1**

**Description: 64mm thk. Single Leaf PSB Fire Rated  
Door with PSB Frame**

**Rating: 90minutes**



# TEST REPORT

No. 0079-23-TR-03-04

Fire resistance of Fire rated single leaf door with PSB frame and Fire rated single leaf door with hard wood frame made according to technical documentation No. J2717-STD-FR-PSB-008 & J2717-STD-FR-PSB-012

according to:

- EN 1363-1:2020
- EN 1634-1:2014+A1:2018

Date of issue:

2 August 2023



## 1 EXCLUSIVE SUMMARY

Test method:	EN 1363-1:2020 – <i>Fire resistance tests - Part 1: General requirements.</i> EN 1634-1:2014+A1:2018 – <i>Fire resistance and smoke control tests for door and shutter assemblies, openable windows and elements of building hardware - Part 1: Fire resistance test for door and shutter assemblies and openable windows.</i>	
Name and address of the testing laboratory:	Emirates Safety Laboratory, Al Warsan III, Dubai, United Arab Emirates.	
Date of specimen(s) delivery:	June 13, 2023	
Date of specimen(s) installation:	June 15, 2023	
Date of testing:	June 21, 2023	
Name and address of the test sponsor:	Abanos Furniture & Decoration Industry LLC P.O. Box 114480 Dubai Investment Park 1 Dubai United Arab Emirates 971 4 8851885	
Name and address of the manufacturer/supplier:	Door and Frame Assembly – Abanos Furniture & Decoration Industry LLC P.O. Box 114480 Dubai Investment Park 1 Dubai United Arab Emirates 971 4 8851885	Door and Frame Core – Al Talah Board Manufacturing Co. LTD Abu Dhabi Free Zone (KIZAD), Plot no KHIA4-05 Taweelah, Abu Dhabi, United Arab Emirates
Name of the test specimen:	Fire rated door detail single leaf door with PSB frame (EN - 90 min. Fire rated door) Fire rated door detail single leaf door with hard wood frame (EN - 90 min. Fire rated door)	
Identification of the test specimen(s):	0079-23-03 (Door 1) 0079-23-04 (Door 2)	
Description of sampling procedure including date if applicable:	ESL Testing was not involved in the sampling process. Test specimens were selected, marked and signed by Mr. Deepesh Srivastava from Intertek Middle East (Certification Body) on June 1 <sup>st</sup> , 2023 as shown below and delivered to ESL by the test sponsor. The results apply to the specimens as received.	



## 2 TEST CONDITIONS

Heating temperature of the test element:

Standard temperature-time curve was maintained within its allowable limits according to EN 1363-1. Temperature inside the furnace during the test was measured at a distance of 100mm from the surface of the test element. Heating conditions are shown in Graphs 1 and 2.

Furnace pressure:

Differential pressure in the furnace measured at a height of 0.5m above the level of furnace floor was maintained according to EN 1363-1. A pressure of 0Pa is maintained at the neutral pressure plane, 0.5m above the notional floor level.

The pressure level during the test is shown in Graph 3.

Ambient temperature:

Measured during the test at distance of 2000mm away from the unexposed face of the specimen, at the commencement of the test was 25.2°C.



### 3 DESCRIPTION OF THE TEST SPECIMEN

Constructional details of the single door set dimensions in below table are presented in the technical documentation enclosed to this report.

Table 1.

Measurement	Nominal		Measured by ESL (mm)	
	Door 1	Door 2	Door 1	Door 2
Width of the door leaves	1000	1000	1000	1001
Height of the door leaves	2400	2400	2401	2401
Door frame opening (w x h)	1006 x 2408	1006 x 2408	1006x2411	1008x2410
Door leaf Thickness	64	64	64	64

#### 3.1 Description of the door set

The door leaf of both tested samples is made of palm strand board (PSB) and is surrounded by 6mmx54mm Mahogany wood lipping along its perimeter. The intumescent strip from Lorient is located at the bottom edge of the door leaf for both samples with dimensions of 50mm x 2mm thick.

The first sample (01) is utilizing Mahogany wood as the material for the frame, this includes the architrave, whereas the second sample (02) is having palm strand board (PSB) for both frame and architrave.

The frame of both samples is fixed to the wall using five steel screws having a diameter of 6mm and length of 125mm with plastic plugs, on both left and right side of the opening. The spacing between steel screws is 525mm. The distance between the edges of the door leaf from the steel screws is 150mm. The architrave is fixed onto the frame using wooden glue from RITVER (PW1612) and nails having a diameter of 1.5mm and length of 33.92mm.

The gaps between the door frame and the supporting construction is filled with 813+ fire retardant foam from BOSS products, after curing the excess is then trimmed off and then an intumescent sealant from Lorient is then applied on top of the firestop foam.

The measured weight of the door leaves are 125 kg and 126.5 kg respectively.

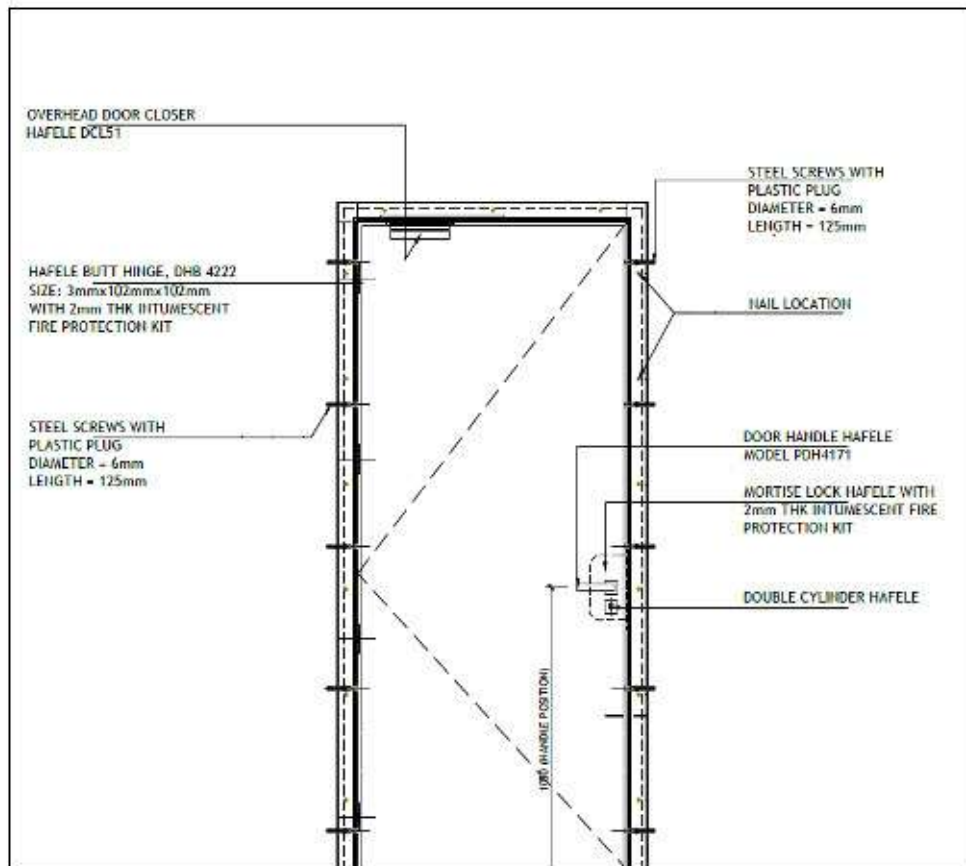

Figure 1. Specimen layout

**Door Ironmongery:****Table 2**

Lock and handle		
		Door 1
Manufacturer		HAFELE
Ref no.	Lock	911.02.145
	Handle	903.92.076
Type		Mortice lock, Profile cylinder
Dimensions		Face plate *23.5 x 228mmx 3mm
Quantity		*1 mortise lock set and *2 Hafele Handles
Components	Door 1	
	2 Lever handle aperture parts with handle roses 1 Spindle 8 x 100 mm 1 Pair of PC escutcheons 4 Threaded screws M4 x 60 mm, can be shortened 1 mortice lock 1 flanged striking plate 2 deadbolt pockets	
Components	Door 2	
	2 Lever handle aperture parts with handle roses 1 Spindle 8 x 100 mm 1 Pair of PC escutcheons 4 Threaded screws M4 x 60 mm, can be shortened 1 mortice lock 1 flanged striking plate 2 deadbolt pockets	
Fixing Method		Fixed *1045mm from the bottom edge of the door leaf

**Table 3**

Lock cylinder		
	Door 1	Door 2
Manufacturer	HAFELE	HAFELE
Ref no.	916.96.027	916.96.027
Type	Profile Cylinder	Profile Cylinder
Quantity	*1	*1
Components	1 double cylinder 3 keys, nickel plated steel 1 fixing screw	1 double cylinder 3 keys, nickel plated steel 1 fixing screw
Fixing Method	Fixed in the mortise lock	Fixed in the mortise lock

Table 4

Door Closer & Hinges				
	Door 1		Door 2	
	Door closer	Hinges	Door closer	Hinges
Manufacturer	HAFELE	HAFELE	HAFELE	HAFELE
Ref no.	931.84.829	926.98.090	931.84.829	926.98.090
Type	Surface mounted	Surface Mounted	Surface mounted	Surface Mounted
Quantity	1	4 pcs.	1 pc.	4 pcs.
Fixing Method	The door closer is installed on the top horizontal edge of the door leaf, on the exposed side.  Hinges are fixed to the door and the frame using 8pcs. of screws fixed at 200mm, 865mm, 1534mm and 2200mm from the sill of the door.			

Table 5

Intumescent Fire Protection Kits				
	Door 1		Door 2	
Manufacturer	HAFELE		HAFELE	
Ref no.	950.11.107	950.11.011	950.11.107	950.11.011
Type	Intumescent for door hinges	Intumescent for mortice locks	Intumescent for door hinges	Intumescent for mortice locks
Quantity	4	1	4	1
Fixing Method	Between door hinges and cut-out of the frame or door leaf	Installed over the mortice lock	Between door hinges and cut-out of the frame or door leaf	Installed over the mortice lock

*Note: The information provided has been compiled based on the information received from test sponsor unless stated differently. Information marked with a single asterisk indicates information provided by the Test Sponsor which has been checked against the materials used in the test where appropriate, however does not fall under the responsibility of ESL.*



### 3.2 Installation

The door leaves were received with the ironmongery already installed into the door. The installation started with the door frame fixed into the supporting construction using steel screws with the dimensions of 6mm x 125mm with plastic plugs.

The door leaves are then installed onto the frame using 4 screws for each hinge with a dimension of 4.5mm x 31mm. The gaps between the frame and the supporting construction is then filled with BOSS 813+ fire retardant foam, after drying, the excess is then trimmed off then the door closer is installed on the door leaves and the exposed foam is then covered with Lorient Intumescent Sealant.

Once the intumescent sealant has dried off, the Architrave is installed on the frame with the use of wood glue from RITVER(PW1612) and nails with dimensions of 1.5mm x 34mm, the arm shoe and forearm are then installed on the architrave and is connected to the door closer.

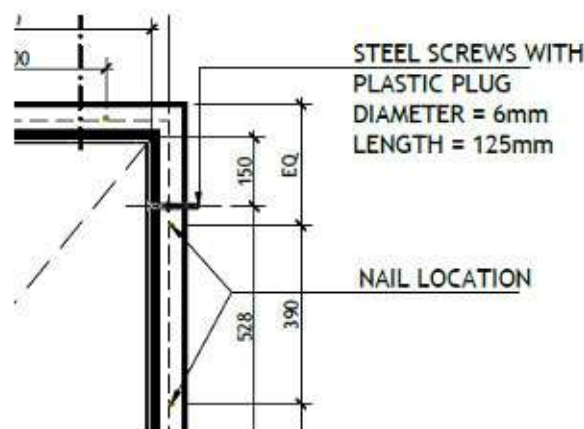

Figure 2. door frame and architrave fixing.

The Lorient intumescent fire seals are then installed, two sets of 20x4mm strips are installed on the allocated locations for the frames, and another one with a strip of the same dimension is installed for the door leaves, an elastomer silicone synthetic rubber is installed adjacent to the strips on the frame. The striker plate is installed on the frame, the location where the striker plate would be installed in the provided cut-out.

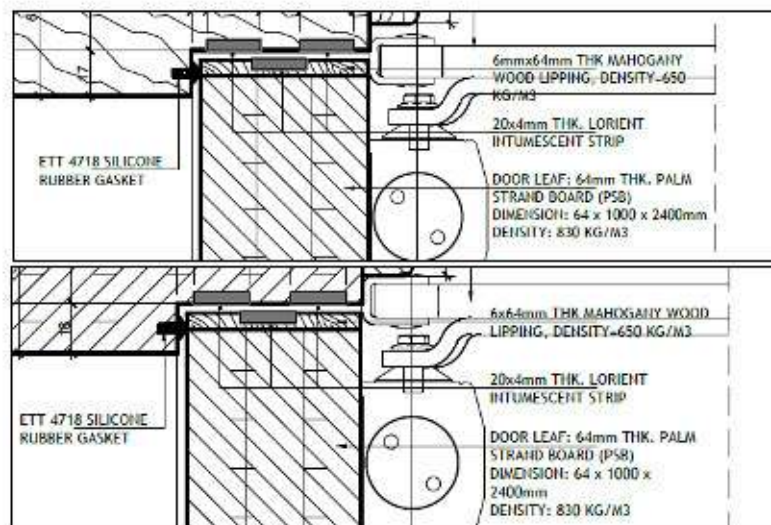

Figure 3. Top edge cross-section of door 1 and door 2 respectively.



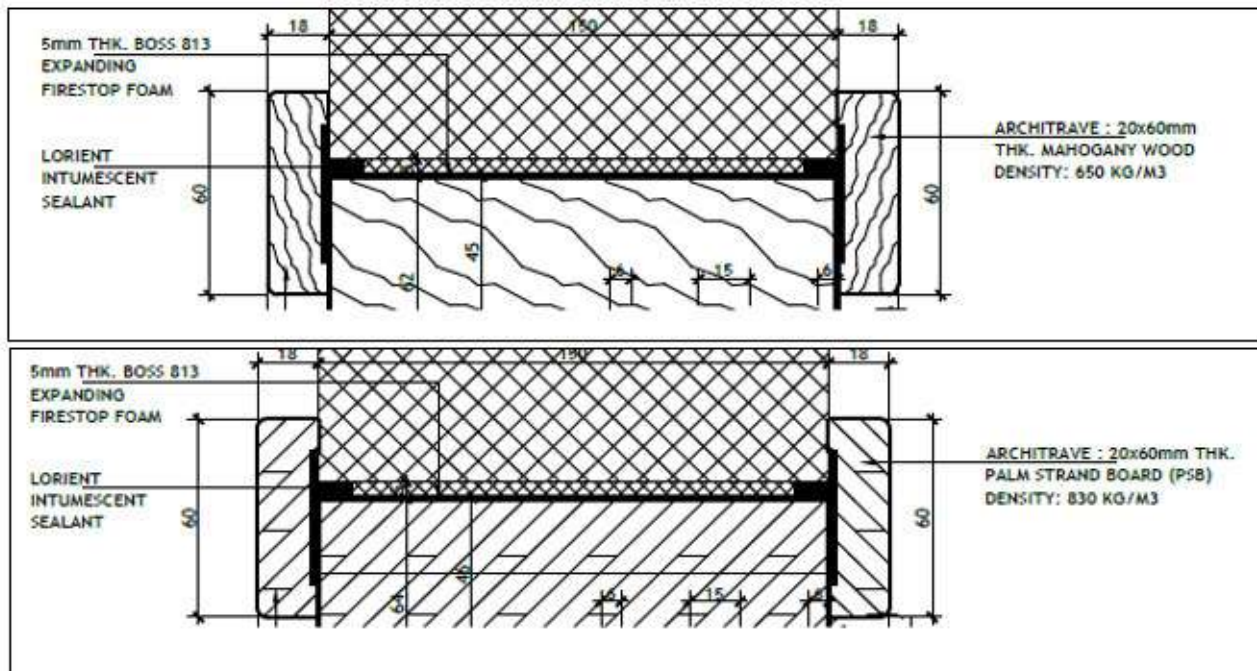

Figure 4. Architrave and frame cross section of door 1 and 2 respectively.

### 3.3 Description of the supporting construction

The door set was installed within a glazed associated supporting construction which was in turn installed within a rigid standard supporting construction (according to EN 1363-1 standard) made of 150mm thick autoclaved aerated concrete blocks with a nominal density of 500kg/m<sup>3</sup> and a structural opening of size 1108mm x 2460mm (w x h). The supporting construction filled the test frame of dimensions 4240x4240mm, made of a steel H-profile. The whole construction was used to close the furnace.

### 3.4 Verification

Verification of the test element(s) was performed before the test, during the assembly and after the test. It included visual inspection of constructional details and its assembly method as well as assessment of dimensions' conformity with technical documentation.

## 4 PRE-TEST PREPARATION

### 4.1 Conditioning

The door set was installed by the manufacturer from 15-Jun-2023 to 19-Jun-2023 in the previously conditioned supporting construction. The test specimen was conditioned for 2 days afterwards under following conditions:

- relative humidity: min RH (%): 35.7, max RH (%): 69.8,
- temperature: min temp. (°C): 24.2, max temp. (°C): 33.9.

### 4.2 Operability test

The test element(s) prior to the fire resistance test and after conditioning was submitted to operability according to EN 16034:2014, by operating 25 cycles of opening to 90° and fully closed of the door leaf. The arm of the door closer is fixed to the door frame.

### 4.3 Closing force measurements

A door closer was installed on the exposed face of both door leaf samples. The maximum closing force of the door leaves 1 and 2, measured prior to the test, to an opening distance of 100mm, was 34.9N and 56.1N respectively.

#### 4.4 Gaps measurements

Gaps measurements made in ESL laboratory are shown in Table 6.

Table 6.

No.	Exposed side (mm)	
	Door 1	Door 2
1	3.29	3.04
2	2.89	2.06
3	2.87	3.11
4	3.36	3.14
5	2.53	3.17
6	3.8	3.46
7	3.65	3.1
8	3.68	3.44
9	3.71	3.34
10	6.74	7.8
11	6.75	7.35
12	7.12	6.99

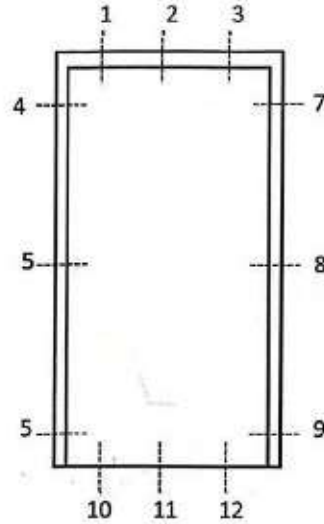

#### Maximum Permitted Gaps

Maximum permitted gaps are shown in Table 7.

Table 7.

GAPS		Measurements, mm					
		Average		Maximum		Permitted gap size	
		D1	D2	D1	D2	D1	D2
Along the horizontal edges	At the top	3.0	2.7	3.29	3.11	5.2	4.9
	At the bottom	6.9	7.4	7.12	7.80	9.0	9.6
Along the vertical edges	Hinge side	3.2	3.3	3.80	3.46	5.5	5.4
	Non-hinge side	3.7	3.3	3.71	3.44	5.7	5.4

#### 4.5 Final settings

Prior to the fire resistance test, the test specimen(s) was subjected to a final closing involving opening the leaf to a distance of approximately 300 mm and returning it to the closed position. The door was latched but not locked and the key was removed from the lock. The door closer is as per normal application on site, connected and operational.

#### 4.6 Arrangement of temperature and deflection measurement points

The positioning scheme of the temperature and deflection measuring points is shown in Figure 4.

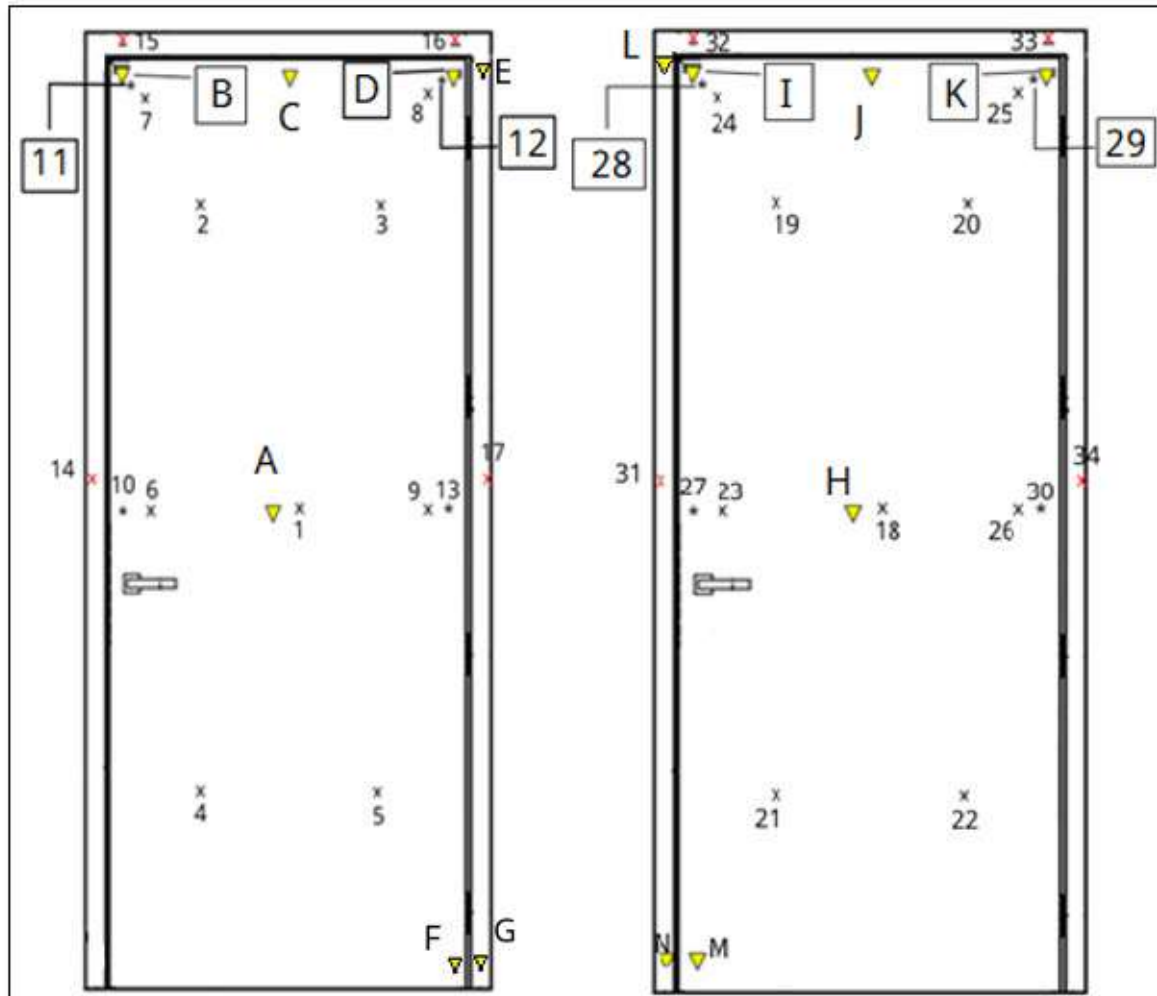
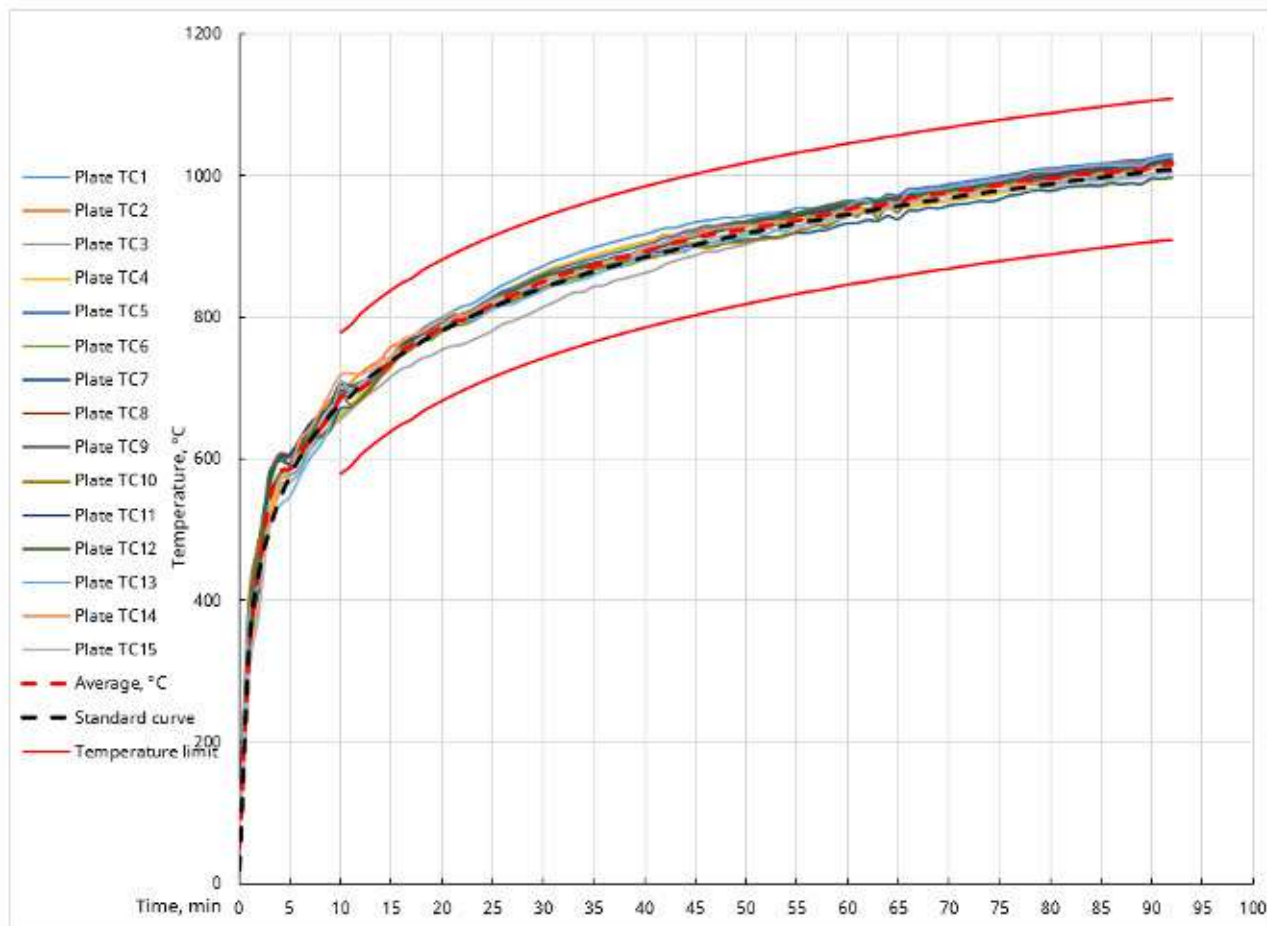

Figure 5. Scheme of the temperature and deflection measuring points on the unexposed side of the door set.

- x - Temperature measuring point (standard procedure).
- x - Temperature measuring point (standard procedure - frame).
- \* - Temperature measuring point (supplementary procedure).
- ▼ - Deflection measuring point.

## 5 TEST RESULTS

### 5.1 Furnace conditions



Graph 1. Temperature in the furnace during the test

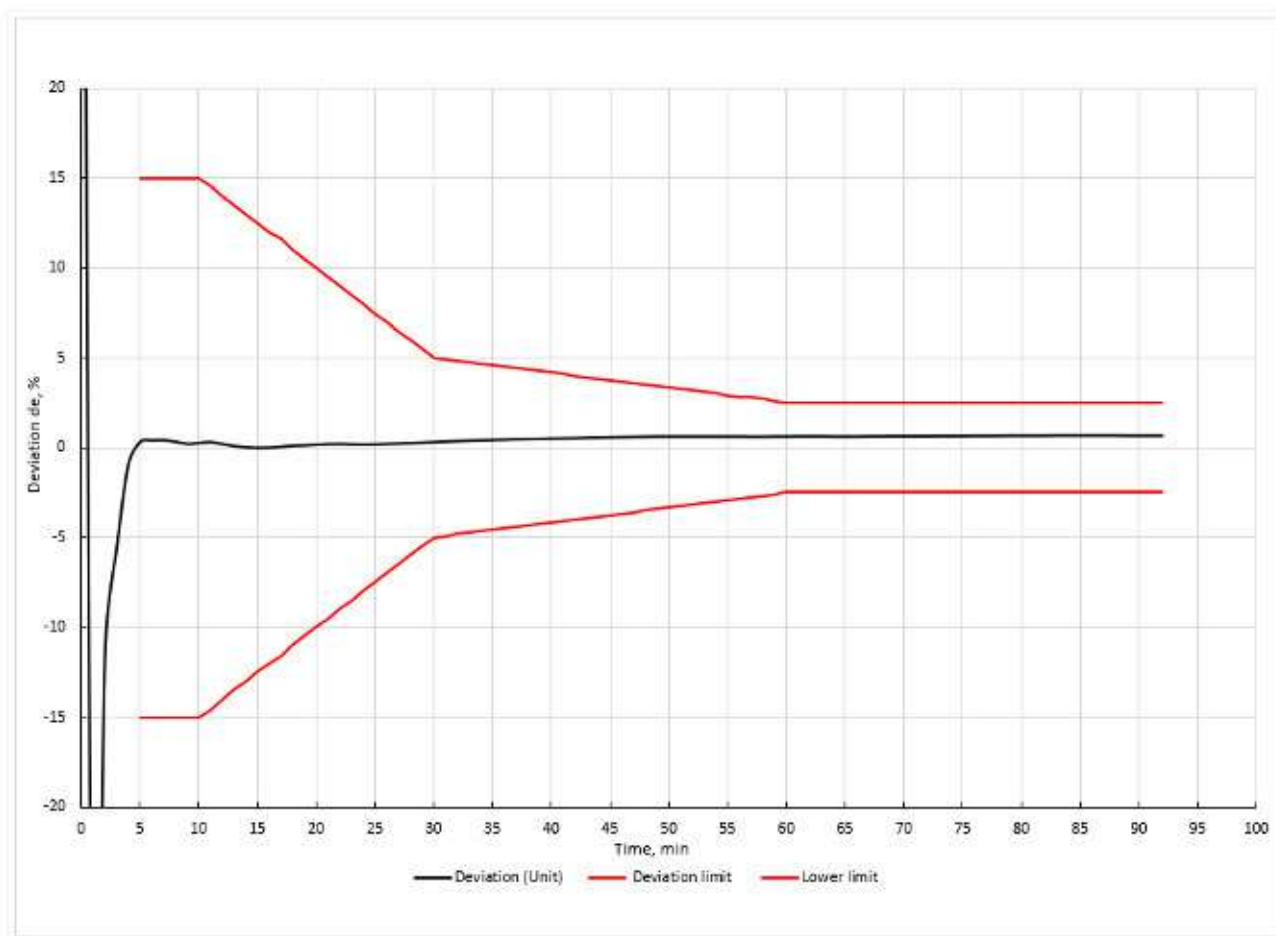

Graph 2. Deviation  $d_e$  with tolerance limits during the test

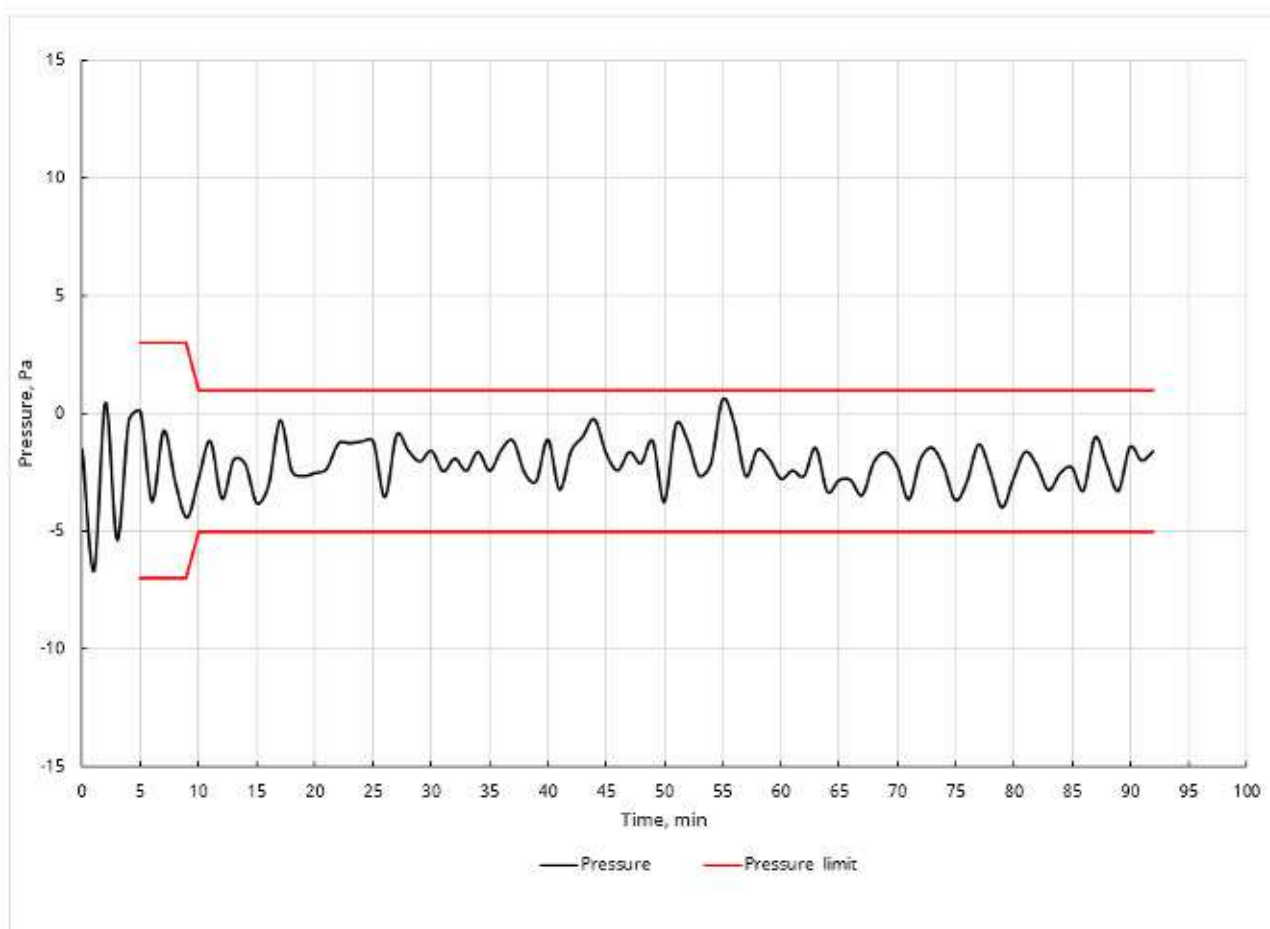

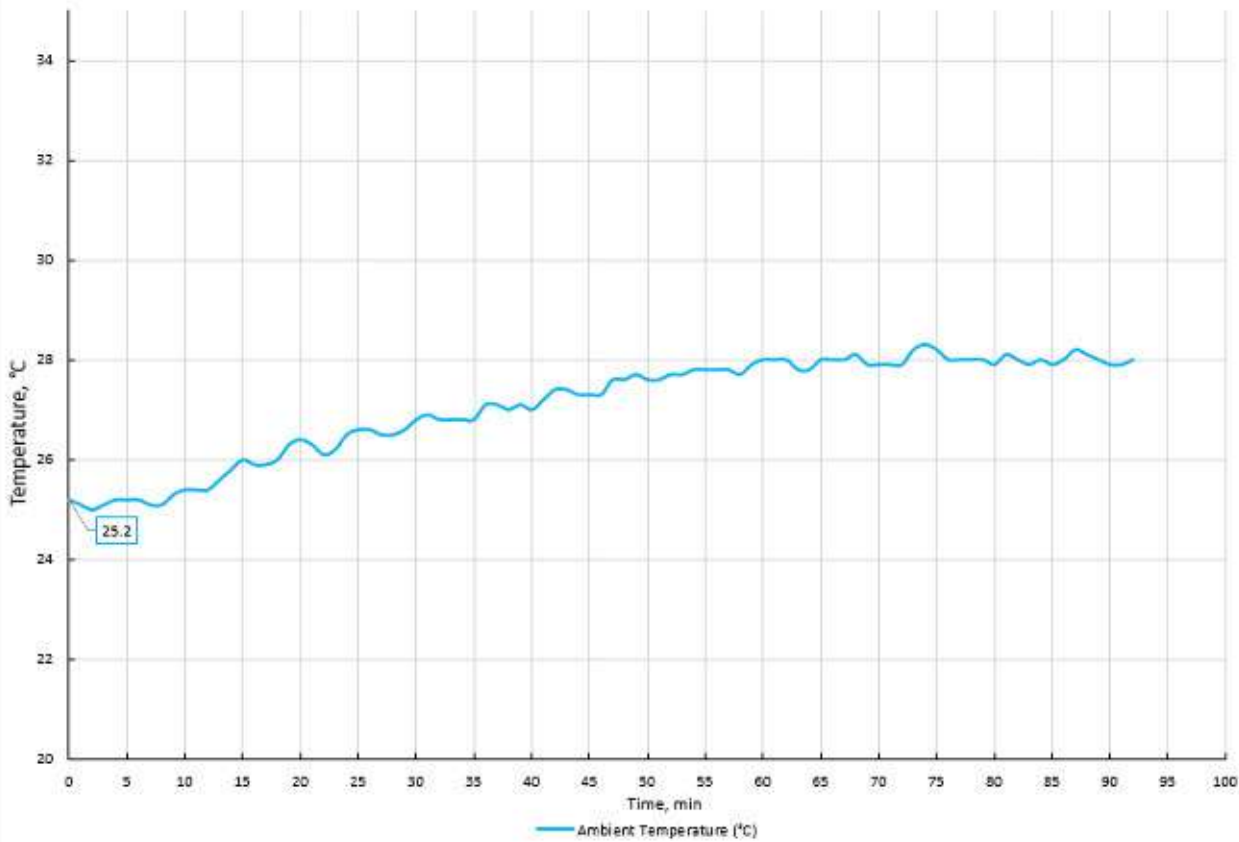

Graph 4. Ambient temperature during the test

## 5.2 Fire test results

### 5.2.1 Observations

Table 8. Observations for door 1 (-03)

Time, (min:sec)	OBSERVATION
0:00	The test started.
4:20	Increased smoke activity.
18:53	Bottom right corner charring.
31:00	Charring on the top left corner.
34:00	Viscous fluid at the bottom left corner of door leaf.
37:25	Increased charring visible at top left corner.
38:50	Moisture dripping down at the mid width of the top edge.
43:09	Charring at the top left edge of the door leaf
44:10	Charring around the key hole.
52:44	Cotton pad application at top left edge, no charring no ignition.
56:10	Increased charring on the top edge and top quarter height of the right edge of the door leaf.
58:10	Increased charring of the keyhole (surrounding).
65:20	Increased smoke activity at top edge, especially top left corner.
68:53	Glowing at the top left corner.
71:15	TC 11 @ 223°C.
73:00	Cotton pad application, no charring no ignition.
76:45	Area of glowing increased.
79:20	Glowing at the top right corner.
81:53	Sustained flaming at the top left corner. - Integrity failure.
91:59	End of test.

Table 9. Observations for door 2 (-04)

[illegible]



## 5.2.2 Deflection measurements

Deflection measurements are shown Table 10.

Table 10.

"+" Deflection towards the furnace "-" Deflection outwards the furnace	Time (min.)	Deflection at the measuring point, mm													
		A	B	C	D	E	F	G	H	I	J	K	L	M	N
	20	-1	+1	0	-2	-1	+4	0	+14	-1	-2	-3	0	0	-2
	40	-2	+3	+1	-2	-3	0	0	0	+1	+1	+1	-4	-2	-1
	60	-10	+1	-2	-3	-5	0	0	-7	+5	+3	-1	-2	-6	-1
	80	/1	/1	/1	/1	/1	/1	/1	-21	+6	+3	+4	+3	+1	-1
	85	/1	/1	/1	/1	/1	/1	/1	-25	/1	/1	/1	/1	-6	-1
	90	/1	/1	/1	/1	/1	/1	/1	/1	/1	/1	/1	/1	/1	/1

/1 - measurements where not taken due to safety concerns on some deflection points and after 50+ minutes onwards

### 5.2.3 Temperature rise & radiation measurements on the unexposed side of the door

Temperature rise on the unexposed side of door set is shown in table 11 and table 12.

Table 11. Temperature rise on the unexposed side of door 1

Time (min)	0079-23-03 (Door 1)																	$\Delta T_{avg}$ Avg.	$\Delta T_{max}$ pts.: Std.	$\Delta T_{max}$ pts.: supp	$\Delta T_{max}$ pts.: Frame
	Standard Procedure									Supplementary procedure				Door Frame				1-5	1-9	10-13	14-17
	1	2	3	4	5	6	7	8	9	10	11	12	13	14	15	16	17	°C	°C	°C	°C
0	0.1	0.7	0.9	0.1	-0.7	0.2	0.9	0.0	-0.5	-0.2	-0.1	-0.1	-0.3	-0.7	0.4	0.4	-1.1	0.2	0.9	0.9	0.2
1	0.1	0.8	0.9	0.2	-0.4	0.3	0.9	0.0	-0.4	-0.3	0.0	0.2	0.0	-0.6	0.5	0.6	-0.7	0.3	0.9	0.9	0.3
2	0.1	0.8	1.0	0.3	-0.5	0.3	0.9	0.0	-0.3	-0.1	0.2	0.0	-0.2	-0.6	0.5	0.4	-0.9	0.3	1.0	1.0	0.3
3	0.2	0.8	0.9	0.2	-0.5	0.3	0.9	0.0	-0.4	-0.2	0.2	0.1	-0.1	-0.6	0.4	0.3	-0.9	0.3	0.9	0.9	0.3
4	0.2	0.8	0.9	0.2	-0.5	0.3	1.0	0.1	-0.4	-0.1	0.3	0.1	-0.1	-0.6	0.4	0.5	-0.9	0.3	1.0	1.0	0.3
5	0.2	0.9	1.0	0.2	-0.5	0.3	1.0	0.1	-0.4	-0.2	0.3	0.2	-0.1	-0.6	0.5	0.4	-1.0	0.4	1.0	1.0	0.4
6	0.2	0.9	0.9	0.2	-0.5	0.4	1.0	0.1	-0.4	0.0	0.4	0.1	-0.1	-0.6	0.5	0.4	-0.9	0.3	1.0	1.0	0.3
7	0.3	0.9	1.0	0.3	-0.4	0.3	1.1	0.2	-0.3	0.2	0.5	0.2	-0.1	-0.6	0.5	0.5	-1.0	0.4	1.1	1.1	0.4
8	0.2	0.9	1.0	0.3	-0.4	0.5	1.1	0.2	-0.2	0.2	0.7	0.5	-0.1	-0.6	0.5	0.5	-1.0	0.4	1.1	1.1	0.4
9	0.3	0.9	1.0	0.4	-0.3	0.5	1.1	0.2	-0.3	0.5	1.0	1.0	0.0	-0.6	0.6	0.5	-0.9	0.5	1.1	1.1	0.5
10	0.3	1.0	1.1	0.5	-0.1	0.6	1.1	0.1	-0.2	1.0	1.4	1.4	0.1	-0.6	0.5	0.5	-0.9	0.6	1.1	1.4	0.6
11	0.4	1.0	1.2	0.6	-0.1	0.5	1.1	0.2	-0.3	1.5	1.7	1.6	0.1	-0.6	0.6	0.4	-0.9	0.6	1.2	1.7	0.6
12	0.4	1.0	1.1	0.4	-0.1	0.6	1.2	0.3	-0.1	2.2	2.4	1.6	0.2	-0.6	0.6	0.5	-0.9	0.6	1.2	2.4	0.6
13	0.5	1.1	1.2	0.6	0.0	0.6	1.3	0.3	-0.1	2.7	3.0	1.9	0.3	-0.6	0.6	0.5	-0.8	0.7	1.3	3.0	0.7
14	0.5	1.1	1.2	0.6	0.0	0.6	1.3	0.2	0.0	3.4	4.1	2.1	0.3	-0.6	0.5	0.4	-0.9	0.7	1.3	4.1	0.7

15	0.5	1.2	1.2	0.6	0.0	0.7	1.4	0.3	0.0	4.1	4.5	2.4	0.3	-0.5	0.6	0.5	-0.9	0.7	1.4	4.5	0.7
16	0.5	1.1	1.2	0.8	0.1	0.8	1.4	0.4	0.0	4.4	4.9	2.8	0.4	-0.5	0.7	0.5	-0.9	0.7	1.4	4.9	0.7
17	0.7	1.2	1.3	0.8	0.3	0.8	1.6	0.6	0.1	5.0	5.2	3.3	0.5	-0.5	0.7	0.6	-0.9	0.9	1.6	5.2	0.9
18	0.7	1.2	1.4	1.0	0.3	0.9	1.6	0.5	0.1	5.1	5.9	3.7	0.5	-0.5	0.7	0.6	-0.7	0.9	1.6	5.9	0.9
19	0.7	1.3	1.4	1.0	0.4	0.9	1.7	0.5	0.2	6.2	6.9	4.3	0.7	-0.4	0.7	0.6	-0.7	1.0	1.7	6.9	1.0
20	0.8	1.3	1.4	1.0	0.4	1.0	1.7	0.6	0.3	6.6	7.4	4.7	0.8	-0.4	0.7	0.5	-0.8	1.0	1.7	7.4	1.0
21	0.9	1.5	1.6	1.2	0.4	1.1	1.8	0.7	0.4	7.0	8.5	5.2	1.0	-0.4	0.6	0.6	-0.7	1.1	1.8	8.5	1.1
22	0.9	1.5	1.6	1.2	0.4	1.3	1.9	0.8	0.5	7.0	11.2	5.7	1.0	-0.4	0.6	0.5	-0.9	1.1	1.9	11.2	1.1
23	1.1	1.7	1.7	1.2	0.5	1.4	1.9	0.9	0.5	7.4	12.7	6.3	1.2	-0.3	0.8	0.7	-0.8	1.3	1.9	12.7	1.3
24	1.2	1.7	1.8	1.3	0.6	1.5	2.2	1.1	0.6	7.9	14.8	6.9	1.4	-0.3	0.9	0.7	-0.7	1.3	2.2	14.8	1.3
25	1.3	1.9	2.0	1.5	0.7	1.6	2.3	1.1	0.6	8.5	17.5	7.7	1.6	-0.3	0.8	0.6	-0.8	1.5	2.3	17.5	1.5
26	1.5	2.0	2.1	1.6	0.7	1.7	2.4	1.3	0.8	8.9	19.6	8.3	1.9	-0.3	0.9	0.7	-0.7	1.6	2.4	19.6	1.6
27	1.5	2.2	2.2	1.7	0.9	2.0	2.5	1.4	0.9	9.4	22.3	9.0	2.1	-0.2	1.0	0.8	-0.7	1.7	2.5	22.3	1.7
28	1.7	2.3	2.4	2.0	1.1	2.1	2.8	1.5	1.1	10.0	26.5	9.8	2.4	-0.2	1.5	0.8	-0.7	1.9	2.8	26.5	1.9
29	1.9	2.5	2.5	2.0	1.2	2.5	2.9	1.6	1.3	10.8	30.0	10.6	2.5	-0.2	1.4	0.8	-0.6	2.0	2.9	30.0	2.0
30	2.0	2.6	2.7	2.3	1.5	2.5	3.2	1.8	1.3	12.6	33.5	11.4	2.9	-0.1	2.1	0.9	-0.6	2.2	3.2	33.5	2.2
31	2.2	2.8	2.9	2.4	1.6	2.8	3.4	2.0	1.6	13.5	39.1	12.3	3.2	-0.1	2.1	0.9	-0.6	2.4	3.4	39.1	2.4
32	2.4	3.1	3.1	2.7	1.9	3.0	3.8	2.2	1.8	13.8	30.1	13.2	3.5	0.0	1.9	1.0	-0.5	2.7	3.8	30.1	2.7
33	2.7	3.3	3.3	2.9	2.0	3.3	4.2	2.5	2.0	16.0	26.3	14.3	3.8	0.0	1.7	1.1	-0.6	2.9	4.2	26.3	2.9
34	2.8	3.6	3.5	3.0	2.2	3.7	4.4	2.7	2.3	18.2	25.0	15.5	4.3	0.0	1.9	1.3	-0.5	3.0	4.4	25.0	3.0
35	3.1	3.8	3.8	3.2	2.6	3.9	4.9	3.0	2.5	21.9	25.8	16.6	4.6	0.0	1.9	1.3	-0.5	3.3	4.9	25.8	3.3
36	3.3	4.0	4.0	3.5	2.8	4.3	5.1	3.3	2.7	25.5	25.5	18.9	5.1	0.0	2.0	1.4	-0.5	3.5	5.1	25.5	3.5

37	3.6	4.4	4.4	3.8	3.1	4.6	5.6	3.7	3.1	27.4	27.0	22.1	5.6	0.1	2.3	1.9	-0.4	3.9	5.6	27.4	3.9
38	3.8	4.6	4.7	4.1	3.7	4.8	5.9	3.9	3.4	29.9	29.6	24.9	6.1	0.1	2.4	2.4	-0.4	4.2	5.9	29.9	4.2
39	4.3	5.1	5.1	4.4	4.1	5.3	6.5	4.3	3.9	30.2	32.4	27.0	6.7	0.1	2.7	2.8	-0.2	4.6	6.5	32.4	4.6
40	4.7	5.4	5.6	4.8	4.5	5.7	7.1	4.8	4.3	30.4	35.5	29.6	7.5	0.2	2.7	3.0	-0.3	5.0	7.1	35.5	5.0
41	5.2	6.0	6.1	5.4	4.7	6.1	7.6	5.3	4.8	29.0	39.8	30.2	8.2	0.2	2.7	2.9	-0.3	5.5	7.6	39.8	5.5
42	5.6	6.6	6.8	5.9	5.5	6.7	8.2	5.8	5.0	28.5	43.8	30.3	9.0	0.2	2.6	2.8	-0.2	6.1	8.2	43.8	6.1
43	6.2	7.3	7.5	6.5	6.3	7.3	8.9	6.5	5.9	29.2	39.6	30.9	9.7	0.2	2.7	2.8	-0.1	6.8	8.9	39.6	6.8
44	7.0	8.2	8.4	7.5	7.0	8.3	9.7	7.3	6.8	29.7	39.9	31.3	10.8	0.4	2.7	3.0	0.0	7.6	9.7	39.9	7.6
45	7.7	9.0	9.1	8.2	7.6	8.9	10.7	8.2	7.7	30.9	42.2	32.1	11.9	0.5	2.9	3.0	0.1	8.3	10.7	42.2	8.3
46	8.3	9.6	9.8	9.1	8.4	9.9	11.5	9.1	8.5	32.1	44.0	33.7	12.8	0.4	3.0	2.7	0.2	9.1	11.5	44.0	9.1
47	9.0	10.6	10.7	10.1	9.1	10.7	12.4	10.0	9.4	33.5	44.6	35.4	13.9	0.4	3.1	2.9	-0.6	9.9	12.4	44.6	9.9
48	9.8	11.4	11.4	11.2	10.0	11.6	13.2	10.8	10.4	34.8	46.9	38.1	14.9	0.4	3.3	2.8	-0.8	10.8	13.2	46.9	10.8
49	10.5	12.3	12.2	11.9	10.6	12.4	14.0	11.8	11.2	36.0	50.5	41.1	16.0	0.5	3.4	3.0	-0.7	11.5	14.0	50.5	11.5
50	11.3	13.3	13.0	12.9	11.3	13.3	15.0	12.8	12.0	36.9	51.7	41.6	16.8	0.6	3.6	3.1	-0.8	12.4	15.0	51.7	12.4
51	12.0	14.1	13.8	14.0	12.2	14.3	15.8	13.7	12.8	37.9	57.2	42.4	17.8	0.6	3.9	3.3	-0.7	13.3	15.8	57.2	13.3
52	12.7	15.0	14.6	14.9	13.1	15.0	16.7	14.6	13.5	38.8	62.3	44.7	18.7	0.7	4.0	3.4	-0.7	14.1	16.7	62.3	14.1
53	13.3	15.7	15.2	15.7	13.7	15.9	17.5	15.5	14.3	39.6	65.1	45.4	19.5	0.7	4.0	3.4	-0.5	14.8	17.5	65.1	14.8
54	14.1	16.4	15.9	16.6	14.3	16.8	18.2	16.3	15.0	40.5	73.9	44.3	20.3	0.7	4.4	3.7	-0.5	15.5	18.2	73.9	15.5
55	14.9	17.3	16.7	17.5	15.1	17.6	19.0	17.1	15.7	42.4	76.5	45.0	21.2	0.8	4.7	3.8	-0.4	16.3	19.0	76.5	16.3
56	15.6	18.2	17.4	18.4	15.9	18.4	19.8	17.8	16.5	43.6	77.6	46.0	22.0	0.8	5.0	3.8	-0.3	17.1	19.8	77.6	17.1
57	16.2	18.9	18.1	18.9	16.5	18.9	20.6	18.6	17.2	45.0	80.4	45.4	22.7	0.9	5.3	3.9	-0.1	17.7	20.6	80.4	17.7
58	16.9	19.7	18.8	19.6	17.4	19.7	21.4	19.3	18.0	46.0	89.0	46.2	23.4	1.0	5.8	4.0	0.1	18.4	21.4	89.0	18.4



59	17.7	20.5	19.5	20.4	18.0	20.4	22.1	19.9	18.6	47.4	96.5	45.9	24.2	1.0	6.5	4.1	0.2	19.2	22.1	96.5	19.2
60	18.3	21.1	20.2	21.1	18.6	21.2	23.0	20.8	19.1	48.3	104.3	46.6	24.9	1.2	7.4	4.5	0.3	19.8	23.0	104.3	19.8
61	18.9	21.8	20.7	21.8	19.3	21.9	23.6	21.4	19.8	49.2	110.1	48.8	25.6	1.2	7.6	4.6	0.4	20.5	23.6	110.1	20.5
62	19.6	22.5	21.4	22.6	19.9	22.5	24.2	22.0	20.5	50.3	114.6	51.6	26.2	1.3	8.1	4.7	0.6	21.2	24.2	114.6	21.2
63	20.2	23.1	22.1	23.2	20.4	23.2	24.9	22.5	21.0	51.1	120.3	55.1	26.8	1.4	8.8	5.1	0.6	21.8	24.9	120.3	21.8
64	20.8	23.6	22.6	23.8	21.1	23.9	25.7	23.1	21.6	52.1	129.5	60.1	27.6	1.5	9.8	5.3	0.8	22.3	25.7	129.5	22.3
65	21.5	24.2	23.2	24.3	21.5	24.5	26.3	23.8	22.1	53.5	136.5	65.5	28.4	1.5	10.3	5.5	0.8	22.9	26.3	136.5	22.9
66	21.9	24.8	23.8	24.8	22.2	25.0	26.9	24.4	22.6	54.7	139.6	68.6	28.9	1.7	11.9	5.9	1.0	23.5	26.9	139.6	23.5
67	22.7	25.3	24.3	25.3	22.6	25.8	27.6	25.0	23.1	55.8	145.2	72.5	29.5	1.6	12.7	6.3	1.1	24.0	27.6	145.2	24.0
68	23.2	25.9	25.0	25.8	23.2	26.3	28.3	25.5	23.6	57.3	152.7	76.4	30.1	1.5	14.8	7.1	1.2	24.6	28.3	152.7	24.6
69	23.6	26.3	25.4	26.3	23.7	26.9	28.8	26.1	24.1	58.6	166.4	79.4	30.7	1.8	15.4	8.1	1.3	25.0	28.8	166.4	25.0
70	24.2	27.0	25.9	26.8	24.2	27.6	29.7	26.7	24.6	60.3	182.8	82.7	31.5	1.9	17.1	7.7	1.4	25.6	29.7	182.8	25.6
71	24.7	27.3	26.4	27.2	24.6	28.1	30.1	27.0	24.9	62.1	201.7	87.6	32.2	2.1	16.4	8.5	1.6	26.0	30.1	201.7	26.0
72	25.1	27.7	26.7	27.6	25.2	28.6	30.9	27.6	25.4	65.1	229.6	96.1	33.6	2.4	15.9	9.3	1.7	26.4	30.9	229.6	26.4
73	25.6	28.2	27.3	28.0	25.5	29.0	31.9	28.1	25.8	68.2	259.7	104.7	34.9	2.4	16.0	8.7	2.0	26.9	31.9	259.7	26.9
74	26.1	28.7	28.0	28.5	25.8	29.6	32.8	28.6	26.3	70.5	282.2	112.2	36.7	2.6	18.4	9.4	2.3	27.4	32.8	282.2	27.4
75	26.5	29.3	28.8	28.8	26.3	30.3	33.8	29.3	26.8	72.4	309.7	118.9	39.4	2.7	23.0	9.8	2.5	27.9	33.8	309.7	27.9
76	27.1	30.1	30.3	29.3	26.9	30.8	35.2	30.1	27.4	73.9	333.3	125.7	43.2	2.9	28.9	10.2	2.7	28.7	35.2	333.3	28.7
77	27.7	31.1	32.2	29.7	27.3	31.5	37.1	31.3	28.3	75.3	349.6	138.5	48.0	3.1	33.2	11.7	2.9	29.6	37.1	349.6	29.6
78	28.4	32.7	35.3	30.4	27.9	32.7	40.4	32.6	29.6	75.9	354.0	155.0	53.5	3.2	39.7	13.5	3.0	30.9	40.4	354.0	30.9
79	29.3	34.9	39.2	31.0	28.5	33.9	45.4	34.7	31.4	76.1	372.8	160.9	58.8	3.4	42.6	17.6	3.4	32.6	45.4	372.8	32.6
80	30.8	38.0	44.6	32.1	29.6	36.0	54.0	38.3	34.3	76.8	395.1	161.9	63.1	3.6	47.9	22.4	3.8	35.0	54.0	395.1	35.0

81	33.2	42.1	51.8	33.9	31.3	39.7	63.2	43.9	38.3	76.7	420.0	171.5	65.1	3.7	56.6	28.7	3.9	38.5	63.2	420.0	38.5
82	36.4	47.7	61.3	36.1	33.9	43.7	70.0	53.7	43.4	76.9	450.0	177.1	66.5	4.1	69.8	32.8	4.1	43.1	70.0	450.0	43.1
83	41.0	51.8	63.6	38.8	37.8	47.8	52.5	67.7	50.9	74.8	319.5	181.4	65.9	4.0	37.0	36.4	4.4	46.6	67.7	319.5	46.6
84	46.3	50.0	50.3	31.6	41.7	37.5	43.3	53.5	56.7	74.0	67.3	101.6	67.6	3.0	32.7	26.2	3.4	44.0	56.7	101.6	44.0
85	53.7	-1.0	47.0	30.2	48.5	35.0	40.8	49.4	58.8	52.2	67.2	165.8	67.5	3.2	31.5	27.7	3.0	35.7	58.8	165.8	35.7
86	-2.8	3.3	-3.4	-5.2	-0.3	-4.7	-2.2	-7.1	2.5	-6.2	-0.4	1.7	-3.9	-6.9	-3.1	1.0	-4.3	-1.7	3.3	3.3	-1.7
87	-3.2	2.4	-5.2	-5.6	-1.2	-1.9	0.1	-7.0	1.3	-7.0	0.3	-1.9	-3.5	-0.5	-3.6	1.1	-2.5	-2.6	2.4	2.4	-2.6
88	-3.4	-3.3	-5.2	-5.0	0.3	-2.7	-2.0	-6.7	0.0	-6.6	1.1	-3.0	-2.8	-1.6	-4.8	2.1	-1.4	-3.3	0.3	1.1	-3.3
89	-4.2	-2.5	-5.6	-5.4	-0.7	-2.4	-2.1	-6.7	-0.3	-6.5	1.3	-3.2	-2.2	-1.7	-5.8	1.9	-1.0	-3.7	-0.3	1.3	-3.7
90	-3.9	-2.3	-5.7	-5.2	-0.7	-2.4	-3.7	-6.4	-0.2	-6.0	1.0	-3.7	-1.8	-1.1	-6.7	1.1	-0.8	-3.6	-0.2	1.0	-3.6
91	-4.5	-4.2	-5.6	-4.8	-0.1	-4.5	-2.9	-6.2	-0.3	-5.7	0.8	-4.1	-1.3	-0.6	-6.8	1.8	-0.9	-3.8	-0.1	0.8	-3.8

Table 11.

Time (min)	0079-23-04 (Door 2)																	$\Delta T_{avg}$ Avg.	$\Delta T_{max}$ pts.: Std.	$\Delta T_{max}$ pts.: supp	$\Delta T_{max}$ pts.: Frame
	Standard Procedure									Supplementary procedure				Door Frame				18-22	1-26	27-30	31-34
	18	19	20	21	22	23	24	25	26	27	28	29	30	31	32	33	34	°C	°C	°C	°C
0	-0.5	-0.2	-0.1	-0.1	-0.3	-0.7	0.4	0.4	-1.1	0.1	0.4	0.5	-0.2	-0.4	0.3	0.5	0.8	-0.2	0.4	0.5	0.8
1	0.6	0.8	1.0	0.4	0.4	0.6	0.7	1.2	0.5	0.0	0.3	0.6	0.1	0.2	0.7	0.5	0.3	0.6	1.2	1.2	0.7
2	0.4	0.6	0.8	0.1	-0.1	0.5	0.6	1.0	0.2	0.0	0.2	0.5	-0.2	0.2	0.5	0.0	0.0	0.4	1.0	1.0	0.5
3	0.4	0.6	0.7	0.1	0.0	0.4	0.5	0.9	0.2	0.0	0.1	0.6	-0.1	0.2	0.4	0.0	0.1	0.4	0.9	0.9	0.4
4	0.2	0.5	0.7	0.1	-0.1	0.4	0.6	1.0	0.1	0.1	0.1	0.6	-0.1	0.2	0.5	0.0	0.0	0.3	1.0	1.0	0.5
5	0.3	0.6	0.7	0.0	0.0	0.5	0.7	1.0	0.1	0.1	0.2	0.9	-0.2	0.1	0.4	0.0	-0.1	0.3	1.0	1.0	0.4
6	0.3	0.6	0.8	0.1	0.0	0.5	0.7	1.1	0.2	0.1	0.2	1.3	-0.2	0.1	0.4	0.0	-0.1	0.4	1.1	1.3	0.4
7	0.3	0.6	0.8	0.1	0.0	0.6	0.6	1.1	0.3	0.3	0.3	2.0	0.0	0.1	0.5	-0.1	-0.1	0.4	1.1	2.0	0.5
8	0.3	0.6	0.7	0.1	0.0	0.6	0.6	1.1	0.2	0.4	0.3	2.6	-0.1	0.2	0.6	0.0	-0.1	0.3	1.1	2.6	0.6
9	0.4	0.6	0.8	0.2	0.0	0.7	0.7	1.1	0.3	0.4	0.4	3.1	-0.1	0.0	0.2	0.0	-0.2	0.4	1.1	3.1	0.2
10	0.4	0.7	0.7	0.3	0.1	0.8	0.7	1.1	0.2	0.7	0.5	3.3	0.0	0.2	0.6	0.0	-0.1	0.4	1.1	3.3	0.6
11	0.4	0.7	0.7	0.3	0.1	0.9	0.9	1.2	0.3	0.6	0.7	3.6	0.1	0.1	0.5	0.0	-0.1	0.4	1.2	3.6	0.5
12	0.5	0.8	0.8	0.3	0.1	1.1	0.9	1.3	0.4	1.0	1.0	4.1	0.0	0.2	0.5	0.1	-0.1	0.5	1.3	4.1	0.5
13	0.5	0.8	0.9	0.5	0.2	1.0	0.9	1.2	0.4	2.0	1.5	4.0	0.1	0.3	0.5	0.1	0.0	0.6	1.2	4.0	0.5
14	0.6	0.9	0.9	0.5	0.2	1.0	1.0	1.3	0.5	2.6	1.9	4.2	0.1	0.2	0.5	0.1	0.0	0.6	1.3	4.2	0.5
15	0.6	0.9	1.0	0.6	0.3	1.0	1.0	1.3	0.5	3.2	2.2	4.4	0.2	0.3	0.6	0.0	0.0	0.7	1.3	4.4	0.6

16	0.7	0.9	1.0	0.6	0.4	1.0	1.0	1.4	0.5	3.6	2.8	4.7	0.2	0.2	0.4	0.1	0.0	0.7	1.4	4.7	0.4
17	0.7	0.9	1.0	0.6	0.3	1.0	1.1	1.5	0.6	4.0	3.2	5.1	0.3	0.3	0.6	0.0	0.0	0.7	1.5	5.1	0.6
18	0.7	1.0	1.1	0.7	0.5	1.1	1.2	1.5	0.6	4.3	3.9	5.4	0.4	0.3	0.5	0.1	0.0	0.8	1.5	5.4	0.5
19	0.9	1.1	1.2	0.8	0.5	1.2	1.3	1.5	0.7	4.9	4.5	6.0	0.5	0.4	0.5	0.1	0.0	0.9	1.5	6.0	0.5
20	0.9	1.1	1.1	0.8	0.5	1.2	1.3	1.7	0.7	5.1	5.1	6.5	0.6	0.3	0.6	0.1	0.1	0.9	1.7	6.5	0.6
21	1.0	1.2	1.2	0.9	0.6	1.3	1.5	1.7	0.7	5.7	5.7	6.9	0.6	0.4	0.6	0.2	0.1	1.0	1.7	6.9	0.6
22	0.9	1.2	1.2	0.9	0.7	1.4	1.6	1.8	1.0	5.9	6.4	7.5	0.7	0.3	0.5	0.2	0.1	1.0	1.8	7.5	0.5
23	1.2	1.4	1.5	1.1	0.7	1.5	1.6	1.8	1.0	6.5	7.2	8.0	0.9	0.5	0.7	0.3	0.1	1.2	1.8	8.0	0.7
24	1.2	1.4	1.5	1.1	0.8	1.7	1.8	2.0	1.2	7.1	8.0	8.5	0.9	0.4	0.7	0.2	0.2	1.2	2.0	8.5	0.7
25	1.3	1.6	1.7	1.3	1.0	1.9	1.8	2.0	1.2	8.0	8.7	8.9	1.2	0.4	0.7	0.3	0.2	1.4	2.0	8.9	0.7
26	1.5	1.6	1.7	1.4	1.1	1.8	2.0	2.2	1.3	9.1	9.3	9.3	1.3	0.5	0.8	0.4	0.3	1.5	2.2	9.3	0.8
27	1.7	1.8	1.9	1.5	1.3	2.1	2.3	2.2	1.4	9.0	10.1	9.8	1.4	0.4	0.8	0.3	0.2	1.7	2.3	10.1	0.8
28	1.8	1.9	2.0	1.7	1.4	2.3	2.3	2.4	1.6	10.2	10.7	10.4	1.9	0.5	0.9	0.3	0.3	1.8	2.4	10.7	0.9
29	2.0	2.1	2.2	1.9	1.7	2.4	2.6	2.6	1.8	10.8	11.5	10.8	2.1	0.6	1.0	0.4	0.3	2.0	2.6	11.5	1.0
30	2.1	2.3	2.4	2.1	1.8	2.6	2.7	2.7	2.0	11.2	12.1	11.2	2.3	0.6	1.0	0.4	0.4	2.2	2.7	12.1	1.0
31	2.4	2.5	2.5	2.4	2.0	2.9	2.9	2.8	2.1	12.2	12.9	11.8	2.6	0.6	1.0	0.5	0.4	2.4	2.9	12.9	1.0
32	2.6	2.7	2.8	2.6	2.3	3.2	3.3	3.1	2.4	13.5	13.8	12.4	2.9	0.6	1.0	0.5	0.4	2.6	3.3	13.8	1.0
33	2.7	2.9	2.9	3.0	2.5	3.4	3.5	3.4	2.6	14.2	14.6	12.9	3.2	0.6	1.2	0.5	0.4	2.8	3.5	14.6	1.2
34	2.9	3.0	3.2	3.1	2.7	3.6	3.8	3.6	2.7	15.0	15.4	13.5	3.6	0.7	1.3	0.5	0.4	3.0	3.8	15.4	1.3
35	3.3	3.4	3.5	3.5	3.0	4.0	4.1	3.8	3.0	16.3	16.4	14.2	4.0	0.7	1.3	0.6	0.5	3.4	4.1	16.4	1.3
36	3.5	3.6	3.7	3.7	3.3	4.3	4.4	4.1	3.4	17.7	17.3	14.9	4.3	0.7	1.4	0.6	0.5	3.6	4.4	17.7	1.4
37	3.8	3.9	4.0	4.0	3.6	4.5	4.7	4.3	3.6	18.3	18.3	15.6	4.7	0.7	1.4	0.7	0.6	3.9	4.7	18.3	1.4



38	4.1	4.2	4.3	4.2	3.8	4.9	5.0	4.5	3.9	19.2	19.0	16.6	5.2	0.6	1.5	0.6	0.6	4.1	5.0	19.2	1.5
39	4.6	4.7	4.7	4.6	4.2	5.4	5.5	4.8	4.2	19.8	20.0	17.3	5.8	0.4	1.6	0.6	0.6	4.6	5.5	20.0	1.6
40	5.1	5.2	5.0	5.1	4.6	5.8	5.9	5.1	4.5	21.3	21.1	18.4	6.6	0.4	1.8	0.7	0.7	5.0	5.9	21.3	1.8
41	5.8	6.0	5.6	5.5	4.9	6.3	6.5	5.5	4.8	22.2	21.9	19.5	7.1	0.3	2.1	0.9	0.8	5.6	6.5	22.2	2.1
42	6.8	6.8	6.1	6.2	5.6	7.1	7.1	5.9	5.4	23.2	23.2	21.1	7.9	0.4	2.0	1.0	0.8	6.3	7.1	23.2	2.0
43	7.6	7.3	6.7	6.9	6.2	7.8	8.1	6.5	6.1	23.9	24.1	22.5	8.8	0.5	2.1	1.0	0.8	7.0	8.1	24.1	2.1
44	8.5	8.2	7.4	7.6	7.0	8.8	8.8	7.0	6.8	25.2	24.9	23.5	9.7	0.7	2.4	1.4	1.0	7.8	8.8	25.2	2.4
45	9.3	9.2	8.1	8.4	7.7	9.4	9.8	7.6	7.4	26.5	26.2	25.2	10.6	0.7	2.5	1.4	1.1	8.6	9.8	26.5	2.5
46	10.4	9.8	8.8	9.3	8.6	10.3	10.6	8.3	8.3	27.6	27.4	25.9	11.7	0.7	2.6	1.7	1.0	9.4	10.6	27.6	2.6
47	11.2	10.4	9.6	10.1	9.3	11.0	11.2	9.0	9.0	28.9	28.6	27.6	12.5	0.8	2.7	1.8	1.0	10.1	11.2	28.9	2.7
48	12.2	11.3	10.4	11.0	10.3	11.9	12.1	9.9	10.0	30.2	29.9	29.4	13.5	0.9	3.0	1.9	1.2	11.1	12.2	30.2	3.0
49	12.9	11.9	11.2	11.6	11.1	12.8	13.0	10.8	10.8	31.1	30.9	31.0	14.3	1.0	3.2	1.9	1.2	11.8	13.0	31.1	3.2
50	13.7	12.8	12.0	12.6	11.9	13.8	13.8	11.6	11.6	32.6	32.0	31.9	15.4	1.1	3.4	2.0	1.2	12.6	13.8	32.6	3.4
51	14.4	13.7	12.9	13.4	12.6	14.5	14.7	12.6	12.4	34.0	32.9	32.3	16.0	1.0	3.5	2.3	1.4	13.4	14.7	34.0	3.5
52	15.2	14.4	13.5	14.3	13.4	15.4	15.4	13.4	13.3	35.0	33.7	33.7	17.0	1.2	3.8	2.4	1.4	14.2	15.4	35.0	3.8
53	16.0	15.2	14.3	15.0	14.2	16.0	16.2	14.4	14.0	36.2	34.3	34.3	17.8	1.2	3.9	2.6	1.4	15.0	16.2	36.2	3.9
54	16.5	15.7	14.9	15.5	14.9	17.1	17.2	15.3	14.7	37.0	35.0	35.4	18.5	1.4	4.1	2.7	1.6	15.5	17.2	37.0	4.1
55	17.2	16.5	15.6	16.4	15.7	17.9	17.9	16.0	15.4	38.6	35.6	37.4	19.5	1.4	4.4	3.1	1.6	16.3	17.9	38.6	4.4
56	17.9	17.2	16.3	17.0	16.4	18.4	18.6	17.0	16.2	40.1	35.9	38.6	20.2	1.5	4.5	3.2	1.7	16.9	18.6	40.1	4.5
57	18.6	17.9	17.1	17.7	17.2	19.2	19.3	17.7	16.9	41.0	36.5	39.6	21.1	1.7	4.8	3.4	1.7	17.7	19.3	41.0	4.8
58	19.2	18.4	17.7	18.1	17.8	19.8	20.0	18.6	17.6	42.1	36.9	39.7	21.8	1.8	5.0	3.6	1.8	18.2	20.0	42.1	5.0
59	19.8	19.2	18.3	18.9	18.6	20.4	20.6	19.3	18.3	43.9	37.4	40.5	22.5	1.9	5.1	3.7	1.9	18.9	20.6	43.9	5.1

60	20.3	19.8	19.0	19.5	19.2	21.1	21.3	20.1	19.0	45.5	37.9	42.3	23.2	2.1	5.4	3.9	1.9	19.5	21.3	45.5	5.4
61	20.9	20.4	19.6	20.0	19.7	21.8	21.9	20.8	19.6	46.9	38.3	42.5	23.9	2.1	5.4	4.0	2.0	20.1	21.9	46.9	5.4
62	21.4	20.9	20.3	20.6	20.5	22.4	22.5	21.5	20.3	48.2	39.1	43.9	24.7	2.2	5.7	4.3	2.1	20.7	22.5	48.2	5.7
63	22.0	21.6	20.7	21.3	20.9	23.2	23.2	22.0	20.9	49.6	39.9	44.3	25.4	2.4	5.8	4.5	2.2	21.3	23.2	49.6	5.8
64	22.6	22.1	21.4	21.8	21.5	24.0	23.9	22.7	21.5	51.0	40.6	46.1	26.3	2.6	6.1	4.7	2.4	21.8	24.0	51.0	6.1
65	23.1	22.7	22.0	22.3	22.1	24.3	24.2	23.3	22.1	52.0	41.6	47.2	26.8	2.7	6.3	4.8	2.4	22.4	24.3	52.0	6.3
66	23.5	23.2	22.5	22.6	22.7	24.9	24.9	24.0	22.7	53.3	42.8	48.4	27.6	3.0	6.3	4.9	2.6	22.9	24.9	53.3	6.3
67	24.1	23.8	23.1	23.3	23.1	25.7	25.7	24.5	23.1	54.1	44.2	51.9	28.1	2.9	6.4	5.1	2.6	23.4	25.7	54.1	6.4
68	24.6	24.3	23.6	23.8	23.7	26.1	26.2	25.2	23.6	55.4	46.5	54.5	28.9	3.2	6.5	5.6	2.8	24.0	26.2	55.4	6.5
69	25.1	24.8	24.2	24.1	24.2	26.6	26.8	25.6	24.1	56.8	50.2	57.9	29.5	3.3	6.6	5.9	2.9	24.4	26.8	57.9	6.6
70	25.7	25.5	24.7	24.8	24.6	27.3	27.3	26.3	24.8	58.2	55.9	61.1	30.3	3.4	6.9	6.3	2.9	25.0	27.3	61.1	6.9
71	25.7	25.9	25.2	25.2	25.2	27.9	27.9	26.9	25.3	59.8	60.8	64.3	30.8	3.6	7.0	6.6	3.0	25.4	27.9	64.3	7.0
72	26.4	26.4	25.7	25.8	25.7	28.5	28.3	27.5	25.8	62.7	66.2	66.8	32.0	3.9	7.1	7.1	3.2	26.0	28.5	66.8	7.1
73	27.2	26.9	26.2	26.3	26.3	29.1	28.8	28.0	26.3	65.9	68.9	69.3	33.1	4.0	7.6	7.5	3.2	26.5	29.1	69.3	7.6
74	27.9	27.5	26.9	26.7	26.8	30.0	29.4	28.6	26.9	70.6	70.0	72.7	34.6	4.3	7.9	7.7	3.4	27.1	30.0	72.7	7.9
75	29.0	28.3	27.6	27.7	27.8	30.7	29.9	29.1	27.7	74.0	70.3	76.2	37.9	4.5	8.3	8.2	3.4	28.1	30.7	76.2	8.3
76	30.4	29.2	28.4	28.8	28.7	31.4	30.4	29.8	28.8	75.3	70.5	78.6	43.4	4.7	8.4	9.6	3.4	29.1	31.4	78.6	9.6
77	32.1	30.4	29.4	30.0	29.9	32.8	31.3	30.4	29.9	76.3	70.7	82.9	52.4	5.0	9.0	10.6	3.5	30.3	32.8	82.9	10.6
78	34.4	32.4	30.6	31.9	31.5	35.0	32.2	31.1	31.3	77.3	71.1	85.8	61.4	5.1	9.4	12.0	3.6	32.1	35.0	85.8	12.0
79	37.7	35.3	32.2	34.4	33.5	38.6	33.2	31.8	33.4	77.0	71.0	89.3	66.2	5.3	9.8	13.6	3.8	34.6	38.6	89.3	13.6
80	42.2	39.3	34.7	37.5	36.2	44.2	35.0	32.9	36.4	77.8	71.1	98.4	68.0	5.5	10.2	13.8	3.8	38.0	44.2	98.4	13.8
81	48.3	44.6	37.8	41.4	39.7	51.6	38.7	34.3	40.2	77.5	70.9	110.1	68.5	5.7	10.8	15.1	4.0	42.4	51.6	110.1	15.1

82	55.7	52.2	42.1	46.9	44.4	58.1	47.3	37.0	46.7	78.0	70.5	127.5	68.4	5.8	11.3	16.1	4.2	48.3	58.1	127.5	16.1
83	61.0	63.0	47.8	54.2	52.4	63.2	64.1	42.3	55.8	77.9	70.4	165.8	68.6	6.0	12.3	17.4	4.3	55.7	64.1	165.8	17.4
84	63.4	68.3	55.6	62.4	61.5	65.2	70.8	51.1	62.3	78.3	70.3	185.2	68.4	6.4	13.3	18.3	4.5	62.2	70.8	185.2	18.3
85	63.9	68.9	62.1	65.5	65.6	66.1	71.0	60.1	63.8	78.2	70.2	202.0	68.7	6.5	14.2	18.6	4.5	65.2	71.0	202.0	18.6
86	64.0	68.7	65.6	64.8	66.8	66.2	71.0	66.7	64.2	78.1	69.9	220.5	68.8	6.6	14.7	19.1	5.0	66.0	71.0	220.5	19.1
87	63.8	68.4	66.8	65.3	66.9	66.4	70.7	69.4	64.3	79.7	70.1	235.6	68.9	6.5	15.4	19.0	5.0	66.2	70.7	235.6	19.0
88	63.2	68.4	67.5	65.0	66.6	66.4	70.5	69.8	63.9	82.4	70.4	252.5	68.9	6.7	15.8	19.4	5.1	66.1	70.5	252.5	19.4
89	63.0	68.2	67.5	64.7	67.1	66.0	70.1	70.4	63.7	86.8	70.4	284.1	68.6	6.9	16.1	21.6	5.2	66.1	70.4	284.1	21.6
90	62.4	67.8	67.2	63.9	66.9	68.0	69.9	71.4	63.6	104.0	70.8	308.0	68.3	7.0	17.4	25.5	5.7	65.6	71.4	308.0	25.5
91	62.3	67.0	66.6	65.0	66.8	72.0	70.0	71.3	63.5	155.9	73.5	338.2	68.3	7.2	20.8	27.0	5.7	65.5	72.0	338.2	27.0



## 6 PHOTOGRAPHS

### 6.1 Unexposed side view of the test specimen

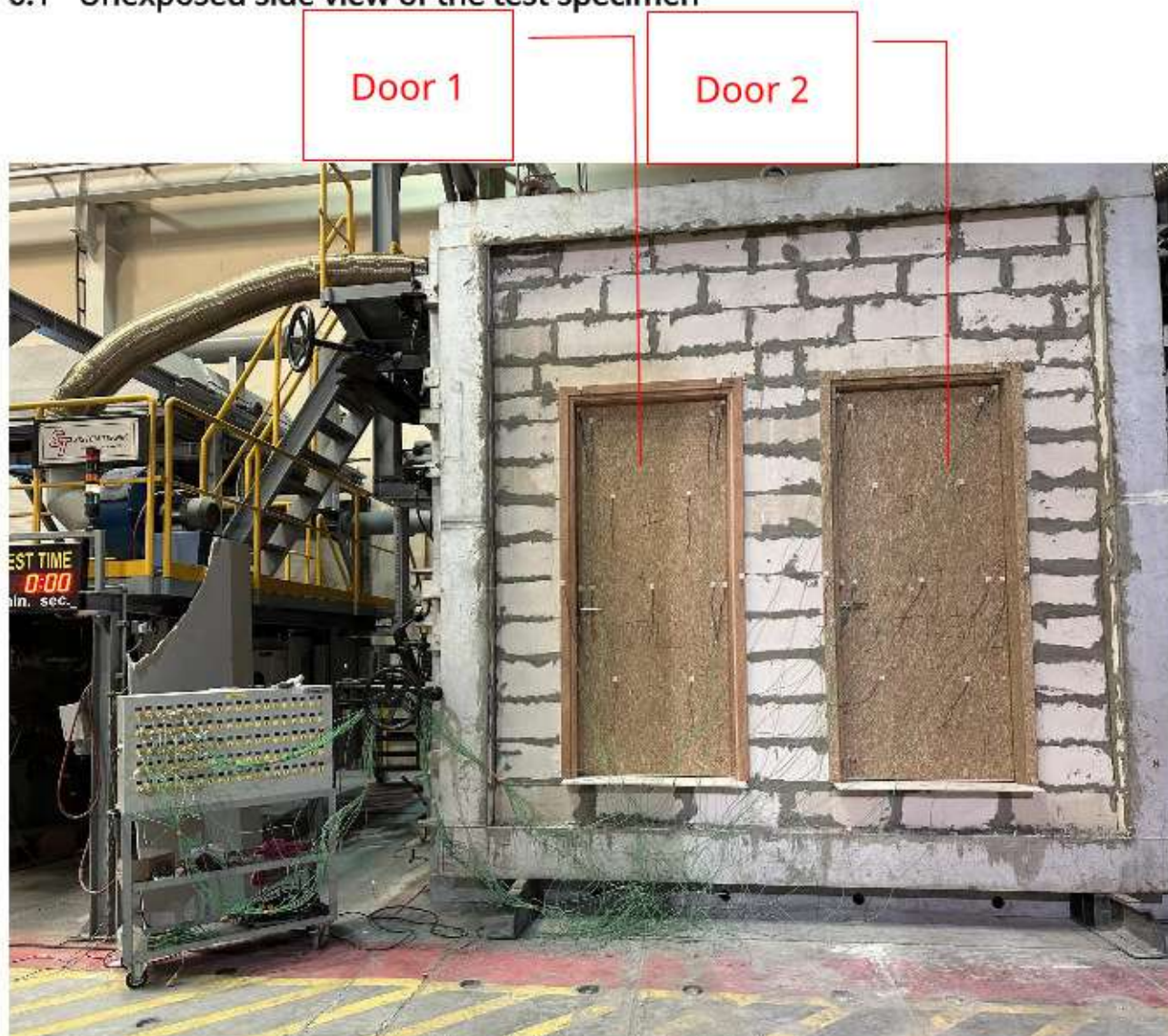

Photo 1. At 00:00 seconds into the test.





Photo 2. At 82:20 minutes after Door #1 has failed due to sustained flaming.



Photo 3. At 91:30 minutes after Door #2 has failed due to sustained flaming.



## 6.2 Exposed side view of the test specimen



Photo 4. Before the start of the test.

*Note: Due to the complete burning of both doorsets, it was not possible to retain them after the test. Extinguishment was exercised right after the test.*

## 7 SUMMARY OF TEST RESULTS

Results of the fire resistance test of fire rated door detail single leaf door with PSB frame (EN - 90 Min. Fire rated door) and fire rated door detail single leaf door with hard wood frame (EN - 90 Min. Fire rated door) are presented in tables 7-12, graphs 1-4 and photos 1-3, refer only to the construction described in clause 3 of herein test report.

Table 12. Summary of the test results

Performance criteria	Description of the criterion requirements	Time and location of criterion failure		Test result	
		Door 1	Door 2	Door 1	Door 2
Integrity, E	Sustained flaming	81:51 minutes [Top left corner of the door leaf]	90:41 minutes [Mid-height, door handle area]	81 minutes	90 minutes
	Gaps disqualifying the product	No Failure	No Failure		
	Ignition of the cotton pad	No Failure	No Failure		
Insulation, I <sub>2</sub>	Average temperature rise (≤140 °C)	No Failure	No Failure	81 minutes	90 minutes
	Maximum temperature rise (≤180°C)	No Failure	No Failure		
	Maximum temperature rise at the door frame (≤360°C)	No Failure	No Failure		
Insulation, I <sub>1</sub>	Average temperature rise (≤140 °C)	No Failure	No Failure	69 minutes	83 minutes
	Maximum temperature rise (≤180°C)	70 minutes [TC 11]	84 minutes [TC 29]		
Duration of the test: 91 minutes					
Note: Heat flux meter is not used for this test.					

*Because of the nature of fire resistance testing and the consequent difficulty in quantifying the uncertainty of measurement of fire resistance, it is not possible to provide a stated degree of accuracy of the result.*

*This report details the method of construction, the test conditions and the results obtained when the specific element of construction described herein was tested following the procedure outlined in EN 1363-1. Any significant deviation with respect to size, constructional details, loads, stresses, edge or end conditions other than those allowed under the field of direct application contained in the EN 1634-1 standard is not covered by this test report.*

## 8 FIELD OF DIRECT APPLICATION OF TEST RESULTS

### 8.1 General

The field of direct application defines the allowable changes to the test specimen following a successful fire resistance test. These variations can be applied automatically without the need for the sponsor to seek additional evaluation, calculation or approval.



## 8.2 Materials and construction

### 8.2.1 General

Unless otherwise stated in the following text, the materials and construction of the doorset shall be the same as that tested. The number of leaves and the mode of operation (e.g. sliding, single action or double action) shall not be changed.

### 8.2.2 Specific restrictions on materials and construction

The thickness of the door panel(s) shall not be reduced but may be increased.

The door panel thickness and/or density may be increased provided the total increase in weight is not greater than 25 %.

For timber-based board products (e.g. particle board, blockboard, etc), the composition (e.g. type of resin) shall not change from that tested. The density shall not be reduced but may be increased.

The cross-sectional dimensions and/or the density of the timber frames (including rebates) shall not be reduced but may be increased.

### 8.2.3 Decorative finishes

#### 8.2.3.1 Paint

As unfinished test specimens were tested then Where the paint finish is not expected to contribute to the fire resistance of the door, (alternative)paints are acceptable and may be added to door leaves or frames for which unfinished test specimens were tested. Where the paint finish contributes to the fire resistance of the door (e.g. intumescent paints) then no change shall be permitted

#### 8.2.3.2 Decorative laminates

Decorative laminates and timber veneers up to 1,5 mm thickness may be added to the faces (but not the edges) of doors that satisfy the insulation criteria (normal or supplementary procedure).

Decorative laminates and timber in excess of 1,5 mm thickness shall not be added without additional test.

### 8.2.4 Fixings

The number of fixings per unit length used to attach doorsets to supporting constructions may be increased, but shall not be decreased and the distance between fixings may be reduced but shall not be increased.

### 8.2.5 Building hardware

The number of hinges and dog bolts may be increased but shall not be decreased.

NOTE 1 The number of movement restrictors such as locks and latches is not covered by direct application.

As the doorset has been tested with a door closing device fitted and with the retention force applied, then the doorset may be provided only with that closing device.

NOTE 2 Interchange of building hardware is not covered by the field of direct application.

## 8.3 Permissible size variations

### 8.3.1 General

Doorsets of sizes different from those of tested specimens are permitted within certain limitations as shown below

#### 8.3.1.1 For size variations

No increase is allowed. Unlimited reductions from the tested specimen are permitted

### 8.3.1.2 Other changes

For smaller doorset sizes the relative positioning of movement restrictors (e.g. hinges and latches) shall remain the same as tested or any change to the distances between them will be limited to the same percentage reduction as the decrease of test specimen size.

### 8.3.1.3 Timber constructions

The number, size, location and orientation of any joints in the timber framing shall not be changed.

### 8.3.1.4 Gaps

Table 13. Maximum allowable gaps

GAPS		Measurements, mm					
		Average		Maximum		Permitted gap size	
		D1	D2	D1	D2	D1	D2
Along the horizontal edges	At the top	3.0	2.7	3.29	3.11	5.2	4.9
	At the bottom	6.9	7.4	7.12	7.80	9.0	9.6
Along the vertical edges	Hinge side	3.2	3.3	3.80	3.46	5.5	5.4
	Non-hinge side	3.7	3.3	3.71	3.44	5.7	5.4

The minimum size of the primary gaps may be reduced.

The permitted gap size may be different for different parts of the door

## 8.4 Asymmetrical assemblies

As the wooden doorset were tested opening into the furnace then other direction (away of the furnace) is also covered.

## 8.5 Supporting constructions

### 8.5.1 General

The fire resistance of a door assembly tested in one form of standard supporting construction may or may not apply when it is mounted in other types of construction

### 8.5.2 Rigid standard supporting constructions (high or low density)

The fire resistance of a doorset tested in a high- or low-density rigid standard supporting construction as specified in EN 1363-1 can be applied to a doorset mounted in the same manner in a wall provided the density and the thickness of the wall are equal to or greater than that in which the doorset as tested.

### 8.5.3 Specific rules for hinged or pivoted doorsets

a) For timber door leaves hung in timber frames, the result of a test in a rigid standard supporting construction is applicable to that door assembly mounted in a flexible construction.

The rules above assume that the fixing methods used in each type of supporting construction are appropriate to that construction. Thus for example in a), the test on the timber door leaf in a timber frame will have been carried out with appropriate fixings for timber frames in rigid constructions. The result is applicable to a timber door leaf in a timber frame mounted into a flexible construction with appropriate fixings for timber frames in flexible constructions.

## 9 TEST WITNESSES

Test sponsor representative(s) witnessing the test.	Name	Company
	Preman Mavilakkandy	Al Talah Board
	Rodrigo Afonso Candeo	
	Deepesh Srivastava	Intertek
	Anselmo Tabadero	Abanos Furniture and Decoration Industry
Other people witnessing the test (subject to approval from test sponsor)		

## 10 ATTACHMENTS

Technical documentation No.:

- J2717-STD-FR-PSB-008
- J2717-STD-FR-PSB-012
- Door Handle Sets (Model PDH4171) - 903.92.076
- Intumescent Fire Protection Kits
  - o Hinge – 950.11.107
  - o Mortice lock – 950.11.011
- Door lock – 911.02.145
- Lock cylinder – 916.96.027
- Butt hinge – 926.98.090
- Door Closer (DCL 51) – 931.84.829
- Boss 813+ Firestop.
- Fire seal
  - o LP2004
  - o Lorient Palusol
- Intumescent sealant – Lorient
- ETT 4718 SILICONE RUBBER GASKET
- PSB board TDS
- Hardwood Mahogany
- Ritver wood glue - PW1612

## 11 SIGNATORIES

*Prepared by*

Cedric Montecillo  
*Testing Technician*



Signature

*Reviewed by*

Sebastian Ukleja  
*Testing Manager*



Signature

*Authorized by*

Sebastian Ukleja  
*Testing Manager*



Signature

--END OF REPORT--



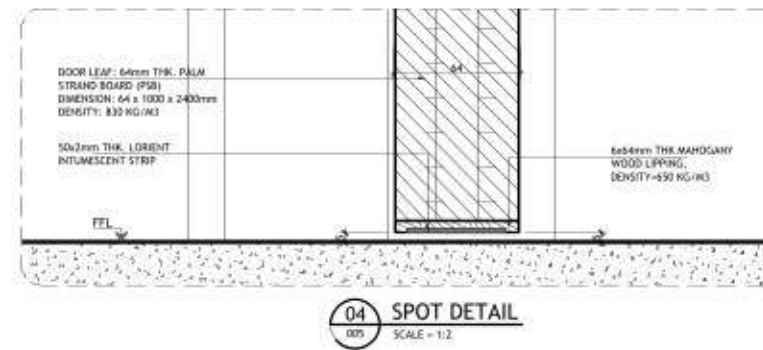
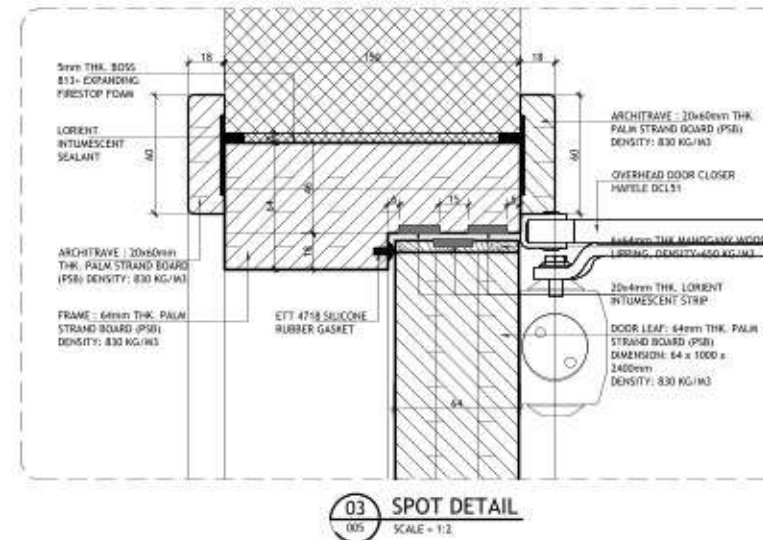
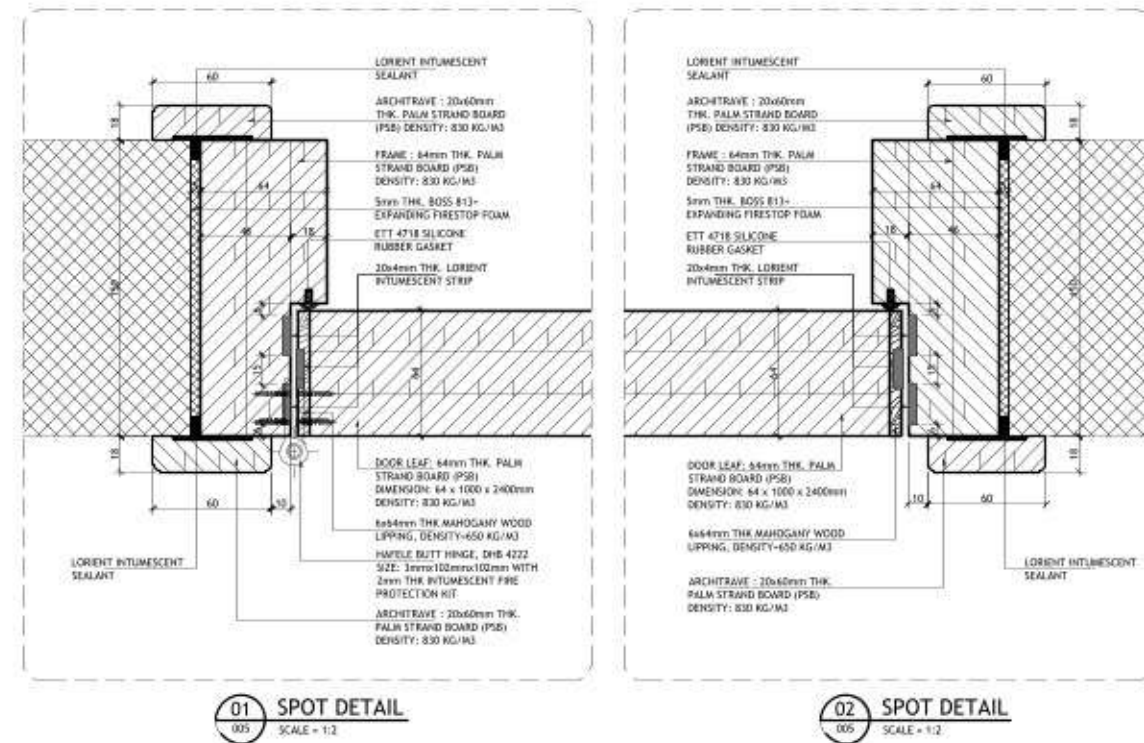
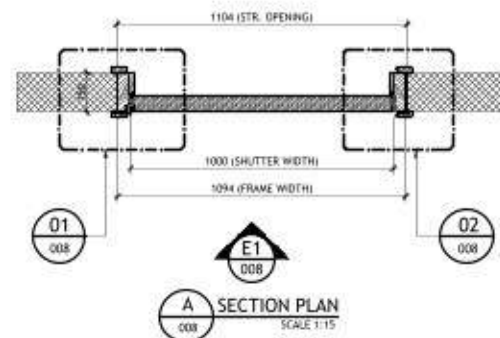
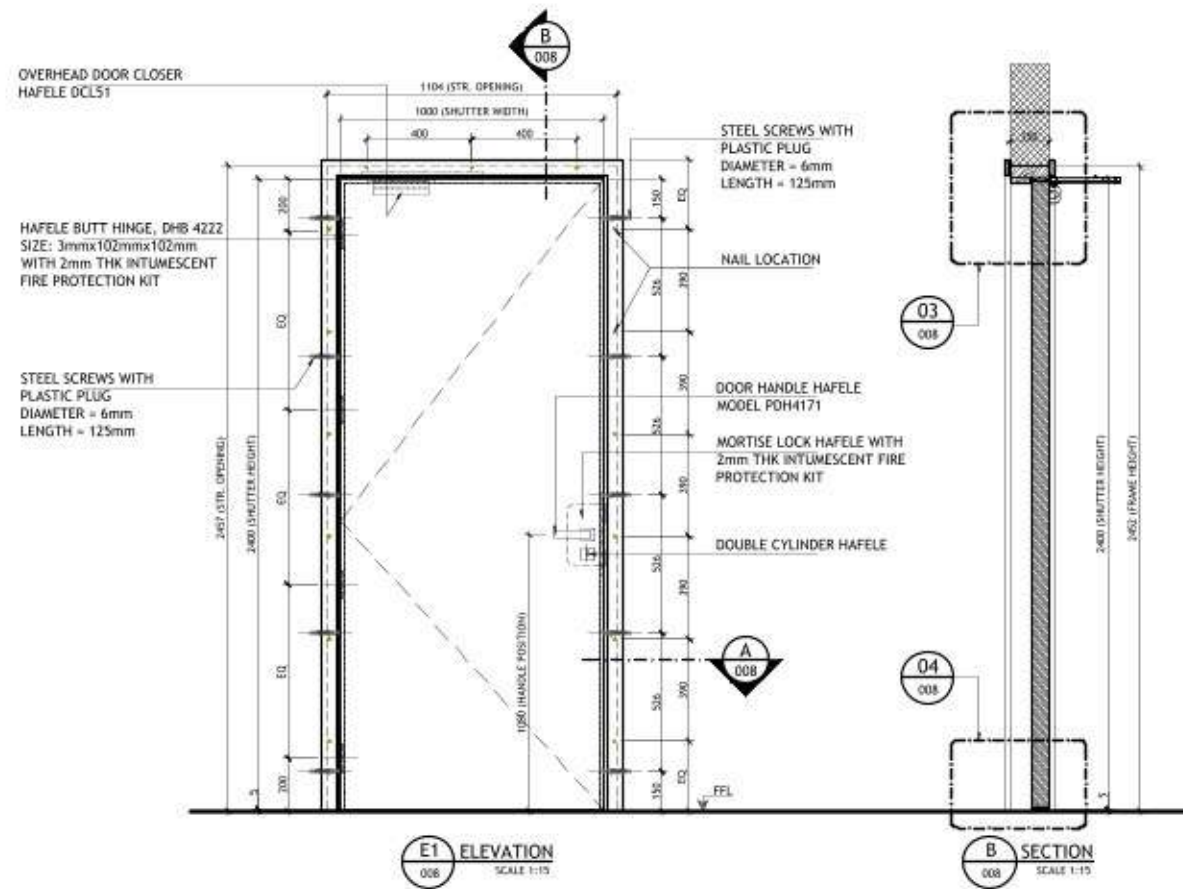

\* THIS DRAWING IS PROPERTY OF ABANOS F.D.I.  
P.O. BOX. 114480, DUBAI, U.A.E.  
TEL: 04 8996111, 04 8851885, FAX: 04 8859966  
IT IS NOT ALLOWED TO REPRODUCE ITS  
CONTENTS IN ANY FORM WITH OUT PERMISSION.

- NOTES:-**
1. ALL DIMENSIONS ARE IN MM UNLESS OTHERWISE NOTED.
  2. FINISH AS PER APPROVED SAMPLE.

Rev.	Date	Description.	By

CLIENT

**ABANOS**

CONSULTANT

MAIN CONTRACTOR

PROJECT

**CERTIFICATION/TEST  
REPORT FOR EN & UL**

SUB- CONTRACTOR



DRAWING TITLE

**FIRE RATED DOOR DETAIL  
SINGLE LEAF DOOR WITH PSB FRAME  
(EN - 90 Min. FIRE RATED DOOR)**

DRAWN BY	CHK.	APPD.	DATE
SJ	.	.	05.05.2023
SCALE	DRAWING NO.	REV.	
1:15 @ A3	J2717/STD/FR-PSB/008	01	





**Model PDH4171**

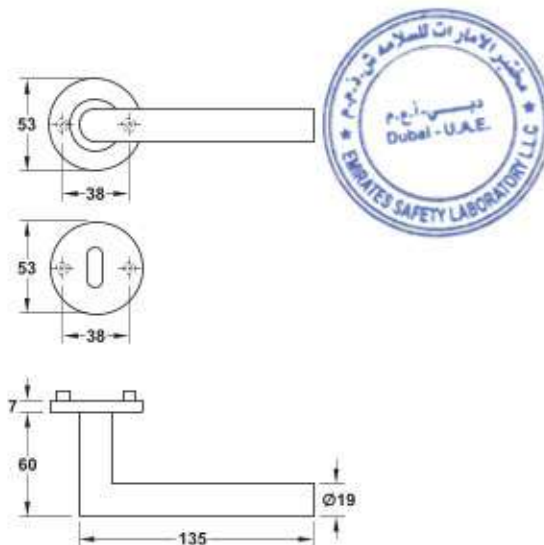

- > Material: Stainless steel, substructure: Steel
- > Bearing: Lever handle pivot-fitted in rose, sprung
- > Standard: Certified in compliance with EN 1906:2010
- > Class: 

4	7	-	B	1	4	0	B
---	---	---	---	---	---	---	---



	Supplied with	Door thickness mm	Satin	Polished	Polished brass coloured, PVD coated
<b>CB set</b> 	2 Lever handle aperture parts with handle roses 1 Spindle 8 x 100 mm 1 Pair of CB escutcheons 4 Threaded screws M4 x 60 mm, can be shortened	38–55	903.91.076	903.91.077	903.91.078
<b>PC set</b> 	2 Lever handle aperture parts with handle roses 1 Spindle 8 x 100 mm 1 Pair of PC escutcheons 4 Threaded screws M4 x 60 mm, can be shortened	<b>F</b> 38–55	903.92.076	903.92.077	903.92.078
<b>WC set</b> 	2 Lever handle aperture parts with handle roses 1 Spindle 8 x 100 mm 1 Pair of WC escutcheons with red/green indicator disc 1 Locking pin 8 x 75 mm 4 Threaded screws M4 x 60 mm, can be shortened	38–55	903.93.076	903.93.077	903.93.078

Individual components	► AH 1.68
Mounting accessories for other door thicknesses	► AH 1.69



## Mortice lock, profile cylinder



2

F

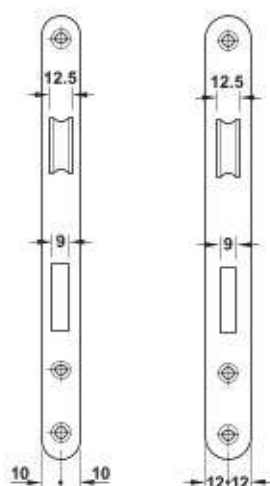
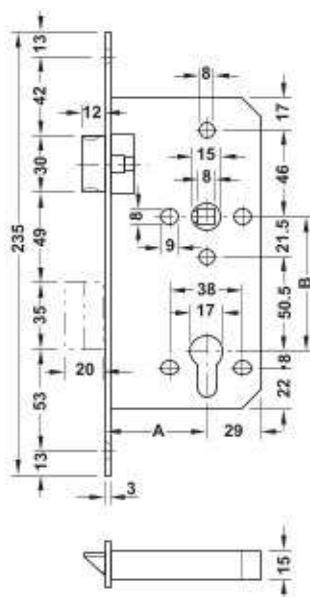
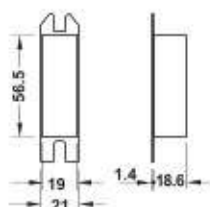
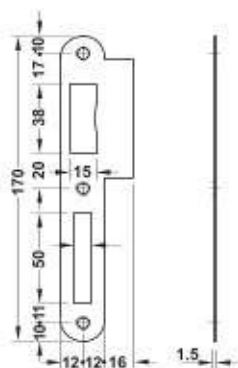

Forend width  
20 mm for  
rebated doors

Forend width  
24 mm for  
flush doors

- > Area of application: For rebated or flush doors
- > Material: Forend, latchbolt and deadbolt: Stainless steel, lock case: Steel, deadbolt pocket: Plastic
- > Type of locking: Prepared for profile cylinder
- > Deadbolt: 2-turn
- > Version: With key action
- > Forend: Round or square
- > Lever follower: 8 mm
- > Distance B: 72 mm
- > Mounting: DIN left and DIN right, reversible
- > Standard: Certified in compliance with EN 12209:2003
- > Class: 3 X 8 1 0 G 3 B C 2 0



### Supplied with

- 1 mortice lock
- 1 flanged striking plate
- 2 deadbolt pockets

Forend width mm	Finish	Square	Round
<b>Backset A 55 mm</b>			
20	Matt brushed	911.02.143	911.02.151
	Brass coloured	911.25.444	911.25.452
	PVD coated		
	Graphite black	911.25.420	911.25.421
24	Matt brushed	911.02.145	911.02.153
	Brass coloured	911.25.446	911.25.454
	PVD coated		
	Graphite black	911.25.422	911.25.200
<b>Backset A 60 mm</b>			
24	Matt brushed	911.02.464	911.02.468
<b>Backset A 65 mm</b>			
24	Matt brushed	911.02.480	911.02.484

### → Intumescent fire protection kit for mortice locks

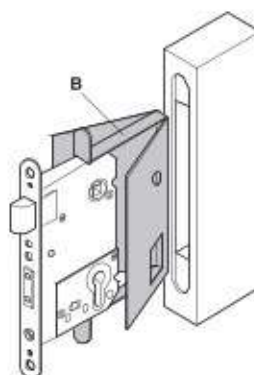

B = intumescent fire protection kit for mortice locks

Dim. (L x W) mm	Material thickness mm	Cat. No.
165 x 90	1	950.11.010
	2	950.11.011

Packing: 1 set

## Profile Cylinder

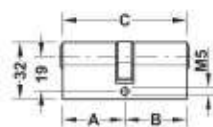

Double cylinder

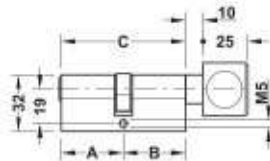

Thumbturn cylinder

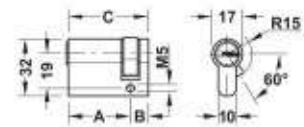

Single cylinder



2

- > Material: Cylinder housing: Brass
- > Finish: Nickel plated
- > Type of locking: Keyed to differ
- > Locking system: With 5 pin tumblers

### Note

No secured locking.

### Supplied with

- 1 cylinder (double, single or thumbturn cylinder)
- 3 keys, nickel plated steel
- 1 fixing screw

Dim. A mm	Dim. B mm	Dim. C mm	Cat. No.
<b>Double cylinder</b>			
31.5	31.5	63	916.59.007
31.5	35.5	67	916.59.008
35	35	70	916.96.066
40	40	80	916.96.027
<b>Thumbturn cylinder</b>			
31.5	31.5	63	916.59.407
31.5	35.5	67	916.59.408
35.5	31.5	67	916.59.410
<b>Single cylinder</b>			
31.5	10	41.5	916.59.202





## Butt hinge

For flush doors

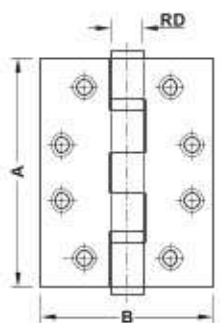
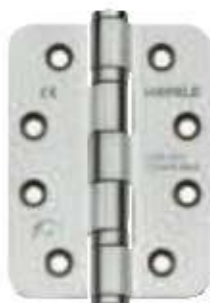
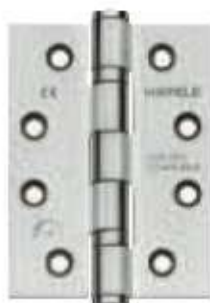

RD = knuckle diameter

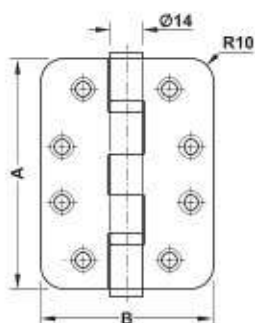

- > Area of application: For wooden frames for flush interior doors
- > Material: Stainless steel
- > Door weight: 120 kg
- > Bearing: With fixed pin, knuckle with two ball bearings
- > Mounting: For DIN left and DIN right hand use
- > Standard: Certified in compliance with DIN 1935:2002
- > Class: 4 7 6 | 1 1 4 | 0 13

### Installation

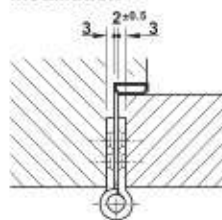

Knuckle Ø mm	Flange thickness mm	Dim. A	Dim. B	Model	Material	Satin	Polished	Burnished	Polished brass coloured, PVD coated	Matt black, PVD coated
Flange shape square										
12	2.5	4"/ 102 mm	3"/ 76 mm	DHB 2122	Stainless steel, quality 201	926.98.010	926.98.011	926.98.019	926.98.018	926.98.013
				DHB 2222	Stainless steel, quality 304	926.98.020	926.98.021	926.98.029	926.98.028	926.98.023
14	3	4"/ 102 mm	3"/ 76 mm	DHB 3122	Stainless steel, quality 201	926.98.030	926.98.031	926.98.039	926.98.038	926.98.033
				DHB 3222	Stainless steel, quality 304	926.98.040	926.98.041	926.98.049	926.98.048	926.98.043
				DHB 3322	Stainless steel, quality 316	926.98.060	926.98.061	926.98.069	926.98.068	926.98.063
		3.5"/ 89 mm	DHB 5222	Stainless steel, quality 304	926.98.100	926.98.101	926.98.109	926.98.108	926.98.103	
		4"/ 102 mm	DHB 4122	Stainless steel, quality 201	926.98.070	926.98.071	926.98.079	926.98.078	926.98.073	
			DHB 4222	Stainless steel, quality 304	926.98.090	926.98.091	926.98.099	926.98.098	926.98.093	
		4.5"/ 114 mm	4"/ 102 mm	DHB 6222	Stainless steel, quality 304	926.98.110	926.98.111	926.98.119	926.98.118	926.98.113
		5"/ 127 mm	3.5"/ 89 mm	DHB 8222	Stainless steel, quality 304	926.98.130	926.98.131	926.98.139	926.98.138	926.98.133
4"/ 102 mm	DHB 9222	Stainless steel, quality 304	926.98.140	926.98.141	926.98.149	926.98.148	926.98.143			
15	3.5	4.5"/ 114 mm	4"/ 102 mm	DHB 7222	Stainless steel, quality 304	926.98.120	926.98.121	926.98.129	926.98.128	926.98.123
Flange shape rounded										
14	3	4"/ 102 mm	3"/ 76 mm	DHB 3221	Stainless steel, quality 304	926.98.050	926.98.051	926.98.059	926.98.058	926.98.053
			4"/ 102 mm	DHB 4121	Stainless steel, quality 201	926.98.080	926.98.081	926.98.089	926.98.088	926.98.083

Packing: 1 or 10 pieces

### Order reference

Fixing screws for wooden frames and doors supplied.

Please order fixing screws for metal frames and doors 020.00.136 separately.

## DCL 51 EN 2-5

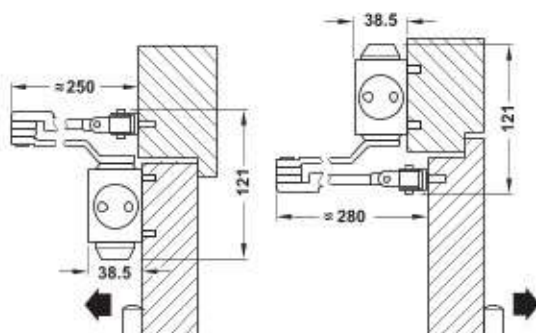
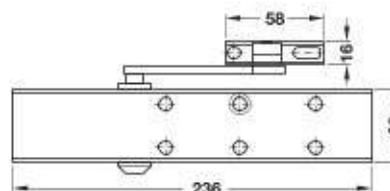

Standard installation  
(door leaf installation)  
on pull side



Overhead installation  
(transom fixing)  
on push side

### Fire resistance and smoke control

**F** Tested for fire resistant and smoke control doors.

> Version:	With standard arm or hold-open arm (optional)
> Installation:	Standard installation on pull side and overhead installation on push side
> Adjustment facility:	Closing speed, backcheck and latching action adjustable
> Closing force:	2-5
> Door width:	≤1,250 mm
> Opening angle:	≤180°
> Hold-open angle:	≤150°
> Mounting:	For DIN left and DIN right hand use
> Standard:	Certified in compliance with EN 1154:1996/A1:2002
> Class:	4 8 2-5   0/1 1 3

		Silver colour lacquered	Satin stainless steel	Brass Polished	Matt black
<b>DCL 51 Set with standard arm</b>					
1 DCL 51 with standard arm	<b>F</b>	931.84.829	931.84.820	931.84.828	931.84.823
<b>DCL 51 Set with hold-open arm</b>					
1 DCL 51 with hold-open arm	—	931.84.669	931.84.660	931.84.668	931.84.663

## Intumescent fire protection kit for door hinges

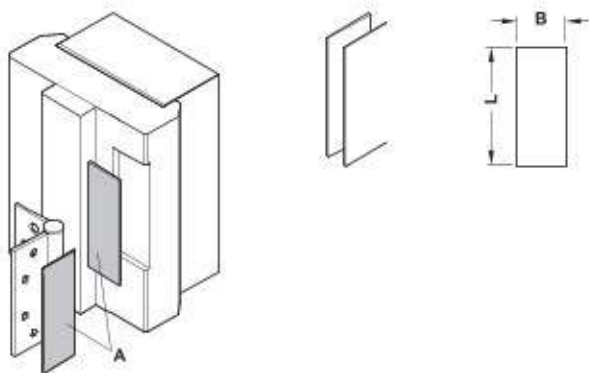

A = intumescent fire protection kit for door hinges

- > Area of application: The material expands substantially when exposed to hot temperatures for protection of door hinges, provides fire resistance of up to 60 minutes
- > Version: Shaped pads of intumescent material, cut to size
- > Material thickness: 2 mm
- > Replaces intumescent wood putty or paste

### Note

The installation must comply with specifications and testing must have been carried out in accordance with EN 1634 in order to guarantee the fire resisting properties of the door. The applicable national and international guidelines, standards, approvals and other relevant regulations with regard to smoke control and fire resistance also have to be taken into consideration.

Dim. (L x W) mm	Cat. No.
76 x 31	950.11.085
102 x 30	950.11.087
102 x 36	950.11.097
102 x 42	950.11.107
126 x 37	950.11.119
114 x 43	950.11.117
114 x 48	950.11.118

Packing: 1 set

Door hinges

► See  
product group 04

## Intumescent fire protection kit for mortice locks

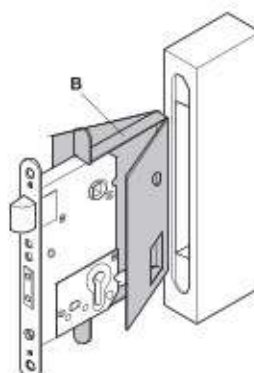

B = intumescent fire protection kit for mortice locks

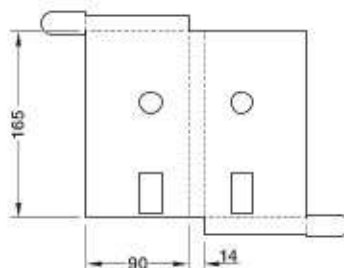

- > Area of application: The material expands substantially when exposed to hot temperatures for protection of mortice locks, provides fire resistance of up to 30 minutes or 60 minutes (material thickness 2 mm), for standard DIN mortice locks, for backset 55 mm, for distance 72 mm
- > Version: Shaped pads of intumescent material, self-adhesive, cut to size
- > Replaces intumescent wood putty or paste

### Note

The installation must comply with specifications and testing must have been carried out in accordance with EN 1634 in order to guarantee the fire resisting properties of the door. The applicable national and international guidelines, standards, approvals and other relevant regulations with regard to smoke control and fire resistance also have to be taken into consideration.

Dim. (L x W) mm	Material thickness mm	Cat. No.
165 x 90	1	950.11.010
165 x 90	2	950.11.011

Packing: 1 set

Door Locks

► See  
product group 02





## BOSS 813+

Revision: 10/06/2020

Page 1 from 2

### Technical data

Basis	Polyurethane
Consistency	Stable foam, thixotropic
Curing system	Moisture curing
Skin Formation (FEICA TM 1014)	9,5 min
Cutting Time (FEICA TM 1005)	50 min
Density**	Ca. 40 kg/m <sup>3</sup>
Thermal conductivity ( $\lambda$ ) (EN 12667)	0,033 W/m.K
Box Yield (FEICA TM 1003)	750 ml yields ca. 34 l of foam
Joint Yield (FEICA TM 1002)	750 ml yields ca. 18 m of foam
Shrinkage after curing (FEICA TM 1004)	< 1 %
Expansion after curing (FEICA TM 1004)	< 1 %
Compressive strength (FEICA TM 1011)	Ca. 70 kPa
Shear strength (FEICA TM 1012)	Ca. 59 kPa
Tensile Strength (FEICA TM 1018)	Ca. 134 kPa
Elongation at Fmax (FEICA TM 1018)	Ca. 14,2 %
Temperature resistance**	-40 °C till +90 °C (cured)

\*\* This information relates to fully cured product.

Soudal NV uses test methods approved by FEICA designed to deliver transparent and reproducible test results, ensuring customers have an accurate representation of product performance. FEICA OCF test methods are available at: <http://www.feica.com/our-industry/pu-foam-technology-ocf>. FEICA is a multinational association representing the European adhesive and sealant industry, including one-component foam manufacturers. Further information at: [www.feica.eu](http://www.feica.eu)

### Product description

Boss 813 FR is a one-component, self-expanding, ready to use PU-foam, which contains HCFC- and CFC-free propellants who are not harmful for the ozonlayer. Boss 813 FR is a PU-foam with fire retardant characteristics according to the European standard EN 1366-4.

- As part of the 'Soudal Fire Range' assortment for penetration seals and joints.
- Sealing of all openings in roof constructions.
- Apply of an acoustic baffle
- All foam applications in static joints.

### Packaging

Colour: pink

Packaging: 750 ml aerosol (net)

### Properties

- Fire resistant in a joint (EN 1366-4)
- High filling capacity
- Good adhesion on all surfaces (except PE, PP and PTFE).
- High insulation value, thermal and acoustic
- Very good bonding properties.
- Not UV-resistant

### Shelf life

15 months unopened and stored in dry and cool conditions (Between 5 and 25 °C), Upright storage is recommended.

### Applications

- Installation of fireproof doors and windows.
- Sealing of fire retardant joints in walls and ceiling.

Remark: This technical data sheet replaces all previous versions. The directives contained in this documentation are the result of our experiments and of our experience and have been submitted in good faith. Because of the diversity of the materials and substrates and the great number of possible applications which are out of our control, we cannot accept any responsibility for the results obtained. Since the design, the quality of the substrate and processing conditions are beyond our control, no liability under this publication is accepted. In every case it is recommended to carry out preliminary experiments. Soudal reserves the right to modify products without prior notice.



## FIRE SEALS

# FIRE SEALS

LP1004, LP1504, LP2004, LP2504

Our intumescent fire door seals offer fire protection where no smoke sealing is required. Combine a fire seal with a Batwing® seal for acoustic + smoke containment. Available in a choice of sizes to cover 30 + 60 minute applications, the fire seal also includes integral antimicrobial protection.



ACOUSTIC, SMOKE + FIRE SEALS



LP1004 Fire seal



LP1504 Fire seal



LP2004 Fire seal



LP2504 Fire seal



Fire seal

## SYSTEM SPECIFICATIONS

### Test evidence

- ▶ Fire: BS EN 1634-1: 2008.
- ▶ Fire: BS 476-22: 1987.

### Performance

- ▶ Protects against fire.
- ▶ Integral antimicrobial protection.

### Size

- ▶ 10 x 4mm.
- ▶ 15 x 4mm.
- ▶ 20 x 4mm.
- ▶ 25 x 4mm.
- ▶ Other sizes available; please ask for details.

### Location

- ▶ Single and double leaf doors.

### Use with

- ▶ Smoke seals and any architectural seals.

### Min/max gap size

- ▶ 3mm/4mm.

### Seal material

- ▶ PVC encased sodium silicate.

### Standard lengths

- ▶ 1m and 2.1m.
- ▶ Other lengths to special order.

### Fixing

- ▶ Heavy duty self-adhesive backing tape.

### Finishes

- ▶ Available in a range of standard colours, plus woodgrain and metallic finishes for superior aesthetics.

### Accreditations



**LORIENT****IP12000/IP14000****"Palusol®"**

## Spec Sheet



### Material Composition:

Palusol® intumescent material consists of a solid sheet of hydrated sodium silicate compound, reinforced with glass fibers and coated on both sides with a barrier film of durable epoxy resin.

### Colors:

Palusol® is available only in its natural white color.

### Size:

Palusol® is available in full-sheet dimensions of 43" x 83", or cut-to-size pieces, to individual order. It is available in either 2mm or 4mm thickness. The material is rigid and all items are shipped flat, not rolled or coiled.

### Temperature Exposure:

Palusol® will remain stable over a wide temperature range.

#### Cold:

Exposure to extreme cold, to -30 degrees F, will not detrimentally affect the material, except that it will become more brittle.

#### Hot:

Exposure to temperatures up to 180 degrees F will not detrimentally affect the material, except that it will become soft and pliable. The material is designed to expand vigorously (intumesce) under continuous exposure to temperatures above 220 degrees F.

### Chemical Exposure:

The epoxy coating on Palusol® material is resistant to all but the most aggressive of chemicals. It is unaffected by common acids, alkalis, salts and organic solvents. Where the coating has been damaged or cut through, care must be taken to reinstate the damaged area, particularly if it will be exposed to humid or damp environments.

### Expansion Characteristics:

Products containing intumescent materials will expand at a variety of rates and temperatures, depending on their chemical composition and other factors. Environmental conditions, the placement of the product and the energy of the heat source may influence the speed or magnitude of the intumescent reaction. The following information serves as a guideline.

#### Temperature for Expansion:

Approximately 220 degrees F, depending on conditions

#### Rate of Expansion:

Between 5:1 and 12:1, based on original thickness of either 2mm or 4mm, and depending on conditions

### Moisture Resistance:

Provided the protective epoxy coating is intact, Palusol® exhibits good resistance to humidity but will require more specialized treatment if continuously exposed to condensation or running water.

### Special Handling Requirements:

Palusol® should be stored flat, preferably in a cool place, but will tolerate temperatures up to 180 degrees F. Extensive tests show that no deterioration in performance takes place even after 25 years storage.

# INTUMESCENT SEALANT



Lorient Intumescent Sealant is a versatile seal solution to fill gaps and movement joints; and for use where rigid seals are impractical.

When exposed to fire, it expands in volume to fill all cavities; providing a necessary hot smoke seal.

It's suitable for sealing gaps between fire resistant walls and floors, between conduits and walls/floors and between fire resistant walls and structural supports. Lorient Intumescent sealant is also recommended for sealing the perimeter of fire and smoke resistant damper/air transfer grilles.



Intumescent Sealant

INTUMESCENT SEALANT

## SYSTEM SPECIFICATIONS

### Test evidence

- ▶ Fire: BS 476-20: 1987.

### Performance

- ▶ Provides effective acoustic containment.
- ▶ Can provide up to 240 minutes fire resistance.

### Material

- ▶ Polymer content increased for improved flexibility - tolerates differential movement in everyday service.

### Finish

- ▶ White as standard. Other colours available to special order

### Applications

- ▶ Specially formulated for adhesion to a wide range of materials including: wood; metal; plastic; concrete; masonry and plasterboard materials.
- ▶ A linear gap seal for gaps in wall and floor constructions and as a linear joint seal where wall and floor constructions abut.
- ▶ A penetration seal around metallic pipes and electrical cables to reinstate the fire resistance performance of wall and floor constructions.
- ▶ Sealing the perimeter around fire and smoke resistant damper/air transfer grilles in doors, walls, ducts floors and ceilings.

### Availability

- ▶ Supplied in individual 310ml cartridges or in boxes of 25 units.
- ▶ Also available in 600ml foils.

### Storage + cleaning

- ▶ Store in cool dry conditions between 5°C - 30°C. Do not allow to freeze.
- ▶ Water based - tools can be cleaned using soap and water.





**DesertBoard.**  
By Al Taha Board Manufacturing Co. LTD



**WORLD'S  
FIRST  
WOODEN  
BOARD  
MADE  
FROM  
DATE  
PALM  
WASTE**

# ABOUT DESERTBOARD



## ABOUT OUR LABS

Desert Board has effectively pledged its reputation as the market leader in the quality of Strand board manufacturing and product innovation. Our labs are equipped with State-of-the-art process control instrumentation, advanced automation, and quality control systems.

With constant strive for success, the Testing Laboratory works with our Research and Development laboratory endlessly to ensure the quality of our product is comparable to the best available in the market at all times.

With the efforts of our laboratories and our management's innovation, we have produced a board that complies with the European Standards EN30:2006 and certified by various local and global entities as a sustainable solution for a better future.







### ABOUT OUR PLANT

With special functions and advanced technologies, our plant can be classified as state-of-the-art. Being the first plant in the world that can transform palm waste into functional palm strand boards, we can ensure that we can lead the market and the industry with confidence.

Our plant is certified by ISO 9001:2015, ISO 14001:2015, and ISO 45001:2018, and our processes are certified by the Forest Stewardship Council, Emirates Green Building Council, and a United Nations signatory of the Global Compact initiative and Climate Neutral Now.

Our plant is equipped with high-efficiency wood dust filtration systems, which are installed for the main manufacturing process as well as at various transfer points to avoid dust emissions into the atmosphere. The plant is controlled by a Central Control Room with built-in software and the latest technologies to recycle up to 80% of wood dust generated during the board manufacturing process for energy production.







**WORLD'S  
FIRST  
WOODEN  
BOARD  
MADE  
FROM  
DATE  
PALM  
WASTE**

# PALM STRAND BOARD



# PSB

## Palm Strand Board



### DESCRIPTION

PSB is an Environmentally-friendly wooden board made from palm waste materials, making it a 100% sustainable board suitable for a wide range of applications. PSB Design is made from PSB Structural boards sandwiched between high density fiberboards that provide a smooth finish and increase the board's durability.

These boards were developed to meet the exacting Al Sa'fat Green Building System and Japanese Industrial Standards (JIS) for formaldehyde emissions. This superior grade F also known as Super E0 (SE0) with Formaldehyde Emissions not exceeding 0.05 mg/kg, has formaldehyde levels similar to natural wood, giving you assurance in the best controls available.

### FEATURES



100% Sustainable



Environmentally Friendly



Zero Emissions



High-Strength & Durable



Load-Bearing Capabilities



Superior Screw Withdrawal



Suitable in Humid Areas



Variation of Finishes

### APPLICATIONS

PSB is a wood-based panel suitable for furnitures, kitchen cabinets and wooden structures such as wall decors, booths, floors and panelling and many more.



Furnitures



Kitchen Cabinets



Booths & Stands



Panelling





# PSB

## Palm Strand Board

### MEASUREMENTS

PSB comes in various sizes and thickness, the standard size for the board is:

2438 mm x 1219 mm (8 ft. x 4 ft.)

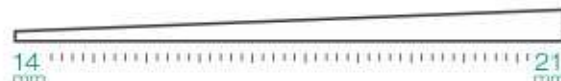

### TESTS

PSB has been tested by Internal and Third-Part Laboratories to ensure the quality of the boards.

PROPERTY	TEST	UNIT	VALUE
Formaldehyde release	EN 717-1	mg/kg	< 0.05
Moisture Content	EN 322	%	3.16
Density	EN 323	kg/m <sup>3</sup>	816.4
Modulus Elasticity	EN 310	N/mm <sup>2</sup>	3592.50
Tensile Strength Perpendicular to the plane	EN 319	N/mm <sup>2</sup>	0.96
Bending Strength	EN 310	N/mm <sup>2</sup>	19.55
Thickness Swelling 2 hours	EN 317	%	3.2
Thickness Swelling 24 hours	EN 317	%	7.78
Screw Withdrawal	EN 320	N	1543
Tolerance on Nominal Dimensions (Thickness)	EN 324	mm	± 0.5
Tolerance on Nominal Dimensions (Length-Width)	EN 324	mm/m	± 0.2
Tolerance on Nominal Dimensions (Squareness)	EN 324	mm/m	± 0.2
Tolerance on Nominal Dimensions (Edge Straightness)	EN 324	mm/m	± 0.2

### CERTIFICATIONS

PSB Design has been tested by Dubai Central Laboratory and other 3rd party laboratories. It has been certified by Dubai Municipality as per Al Sa'fat Green Building System and is in compliance with the European Standards EN300:2006, and BS EN 717-1:2004.





## SPECIFICATION OF AFRICAN MAHOGANY WOOD

MAHOGANY, AFRICAN

WORLD WOODS

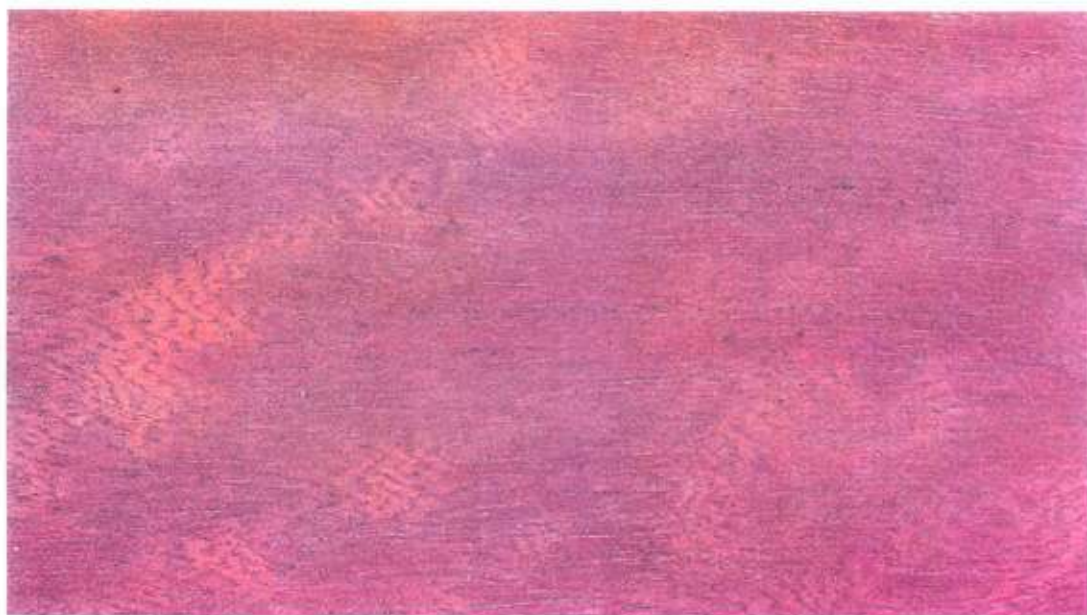

**MAHOGANY, AFRICAN (H)** (1) *Khaya ivorensis*, A. Chév., W. Africa  
(2) *K. anthotheca*, Welw. C.DC., W. and E. Africa  
(3) *K. nyasica*, Stapf. ex Baker.f., E. Africa  
Family: *Meliaceae*

**Other names:** (1) Nigerian, Benin, Lagos or Degema mahogany; (1) and (2) Ghana, Ivory Coast, Takoradi or Grand Bassam mahogany; (2) krala (Ivory Coast), mangona (Cameroon), munyama (Uganda); mbaua (Mozambique), mbawa (Malawi), mkangazi (Tanzania).

**Distribution:** Tropical West, Central and East Africa.

**General description:** Heartwood varies from light to deep reddish-brown. Grain straight to interlocked, moderately coarse textured to medium. Logs may have brittleheart or softheart and cross fractures or heartbreaks. Weight 540-590 kg/m<sup>3</sup> (34-36 lb/ft<sup>3</sup>); s.g. .54 to .59.

**Mechanical properties:** *K. anthotheca* has moderately good wood bending properties, the other types cannot be bent without severe buckling or fibre rupture. The bending strength is low, stiffness and resistance to shock loads is very low and the crushing strength is medium.

**Seasoning:** Dries rapidly with little degrade except where tension wood occurs, causing serious distortion. Small movement in service.

**Working properties:** There is a moderate blunting effect on tools, and tension wood or brittleheart and interlocked grain can cause woolliness. To avoid tearing the grain a reduced cutting angle of from 15° to 20° is desirable. Nailing, screwing and gluing properties are good and it may be stained and polished to an excellent finish.

**Durability:** Liable to insect attack. The heartwood is moderately durable but extremely resistant to preservative treatment and the sapwood is moderately resistant.

**Uses:** Widely used for furniture and cabinetmaking, office, shop and bank fitting, interior joinery, boatbuilding and vehicle bodies. It is extensively used for laminations especially in cold moulded processes. Rotary cut logs are used for plywood and sliced veneers for decorative work.

**Note:** Related spp. include *K. grandifoliola*, C.DC., and *K. senegalensis*, (Desr) A. Juss, both sold as **heavy African mahogany** and sometimes mixed with shipments of lighter species.

**TOLLFREE IN THE UAE - 800 DANUBE**

ص. ب. ١٨٠٢٢، جبل علي - أ.ع.م. ، تلفون : ٠٤-٨٨٧١٢٣٤ ، فاكس : ٠٤-٨٨٧١٢٣٥

P.O. Box-18022, Jebel Ali-U.A.E. Tel.: 04-8871234, Fax : 04-8871235 E-mail : info@aldanube.com www.aldanube.com

FORMED PURSUANT TO LAW NO.2 OF 1986 AND IMPLEMENTING REGULATION NO. 1 OF 1999 WITH LIMITED LIABILITY

**LEADING BUILDING MATERIALS CO. IN MIDDLE EAST**

## WOOD GLUE

Product No. **PW1612**

A water based wood glue based on polyvinyl acetate polymer, designed with excellent high tack and bond strength, developed for various wood carpentry application uses, such as: [ bonding timber, MDF, doors, windows in high speed assembly lines at joineries]  
Product is not suitable for perpetual wet areas like toilets, kitchen sink etc.,

**Virtues: It is a nontoxic and non-flammable water based, environmental friendly single component product.**

### USE

Product is also useful for decorative bonding, cold and hot pressing of decorative laminates, wood veneers to ply, block boards, tiles in dry condition. Etc.

### SPECIFICATIONS

#### Properties

<b>Color</b>	: milky white
<b>Specific gravity</b>	: 1.01 Kg/lit [ $\pm 0.025$ ]
<b>Viscosity 4/25°C</b>	: 180 sec. [ $\pm 1$ ]
<b>Weight Solids</b>	: 43% Kg/Kg [ $\pm 1$ ]
<b>PH</b>	: 5-7
<b>Drying Interval</b>	
<b>Open Tack</b>	: 5-10 min.
<b>Curing</b>	: 60 hrs. [Temperature, humidity, air movement, film thickness and number of coats all affect the drying time.]

### SURFACE PREPARATION

All timber species must be fully aged with a moisture content of less than 15%. Surface must be dry, clean and free from contaminations. Natural oil or gum must be removed by solvent cleaning.

Exclusions for successful application include perpetually wet surfaces and also large cavities on wood surfaces.

### APPLICATION METHODS

**RITVER Wood glue** is generally recommended to be applied without any thinning and as such. During application use a mechanical glue spreader or a convenient spatula. Ensure that the surface is free from dust and oil moieties. Spread the adhesive evenly and leave it for 5 to 10 minutes as per the wood surfaces. Press the surface to be bonded and squeeze out the excess. Remove the non-dried portion with warm water or resort to mechanical removal when dry. Do not apply when wet as there will be no bondage to the substrate. Once used keep the container closed immediately. It is also important to see that the tools used for application is cleaned before the glue dries off.



## WOOD GLUE

Product No. **10W1632**

### PRODUCT PREPARATION

Stir well before use. Thin to the required viscosity ensuring the product is homogeneous.

#### Dilution

By brush, roller

Normally ready to use but we can dilute the product up to 15 % by water.

### SUBSEQUENT TREATMENT

After drying this product, it does not need any subsequent treatment.

### PACKING & STORING

Available in 1Lit, 4Lit ,20Lit and 200Lit .

Store in a cool and well ventilated place. Keep away from direct sunlight. Minimum one year in unopened container, stored in a cool and dry condition at 25°C.

### SAFETY & FLAMMABLE

Do not expose product to direct sun light.

In case of contact with eyes rinse immediately with plenty of sweet water and seek medical

Keep away from sources of ignition. Keep out of reach of children.



Distributed By....



## ETT: 4718 – Technical Data Sheet

### SILICONE BIG HEXAGONAL SEALS

- Material** : Elastomer SILICONE Synthetic Rubber.
- Function** : For Door Sealing, excellent sealing against dust, water and winds, thermal Insulation, shock absorber, good aesthetic appearance. Silicone Rubber Vulcanizates process excellent working properties at high and low temperature.

#### GENERAL PHYSICAL PROPERTIES (ASTM C 1115 Table 2, Type C)

PROPERTIES	SPECIFICATION	TEST METHOD
Hardness(Shore A)	70 ± 5	ASTM D 2240
Tensile strength (MPa.)	5.0	ASTM D 412
Elongation Break (%)	125(min)	ASTM D 412
Compression Set-22Hrs at 100 °C	15(%)Max	ASTM D 395
Heat Ageing 70Hours @ 150 °C		ASTM D 573
Change in Hardness (Shore A)	± 5	ASTM D2240
Change in Tensile Strength (%)	± 15	ASTM D412
Change in Elongation, (%)	± 30	ASTM D412
Ozone Resistance at 70 °C ,300 mPa for 100 Hrs	No Cracks	ASTM D 1149

#### Disclaimer:

This Technical Data Sheet is for reference purpose only and should not be considered as warranty certificate

